

Toggle Pads - Smooth Pad

Toggle pads are used to clamp parts with uneven or angled surfaces. Because the pad swivels 10° in all directions, it is self-aligning against the workpiece surface. Serrated pads are for extra grip and Delrin® pads are used on soft surfaces to prevent marring. Steel pads are case hardened with a yellow zinc finish.

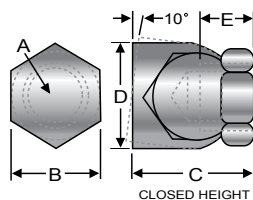

Steel Body

Steel Body and Pad P/N	Steel Body with Delrin® Pad P/N	Thread (A)	Max Load Steel Pads (lbs)	Max load Delrin® Pads (lbs)	Hex Size (B)	Closed Height (C)	Pad Dia. (D)	Thread Depth (E)
SP-1	SP-1D	1/4-20	3,900	360	1/2	5/8	5/8	5/16
SP-2	SP-2D	5/16-18	5,900	360	9/16	3/4	11/16	3/8
SP-3	SP-3D	3/8-16	6,400	570	5/8	13/16	3/4	3/8
SP-4	SP-4D	1/2-13	7,000	570	3/4	15/16	7/8	7/16
SP-5	SP-5D	5/8-11	10,000	1,000	7/8	1	1	7/16
SP-6	SP-6D	3/4-10	13,500	1,300	1 1/16	1 11/32	1 1/4	5/8
SP-7	SP-7D	1-8	18,750	1,570	1 3/8	1 53/64	1 5/8	13/16

Stainless Steel Body

Stainless Steel Body and Pad P/N	Stainless Steel Body Delrin® Pad P/N	Thread (A)	Max Load Stainless Pad (lbs)	Max load Delrin® Pad (lbs)	Hex Size (B)	Closed Height (C)	Pad Dia. (D)	Thread Depth (E)
SP-1S	SP-1SD	1/4-20	5,000	360	1/2	5/8	5/8	5/16
SP-2S	SP-2SD	5/16-18	7,600	360	9/16	3/4	11/16	3/8
SP-3S	SP-3SD	3/8-16	8,250	570	5/8	13/16	3/4	3/8
SP-4S	SP-4SD	1/2-13	9,000	570	3/4	15/16	7/8	7/16
SP-5S	SP-5SD	5/8-11	12,900	1,000	7/8	1	1	7/16
SP-6S	SP-6SD	3/4-10	17,400	1,300	1 1/16	1 11/32	1 1/4	5/8
SP-7S	SP-7SD	1-8	24,200	1,570	1 3/8	1 53/64	1 5/8	13/16



Request Info

1-800-453-1692

www.aboveboardelectronics.com

Toggle Pads-Serrated Pad

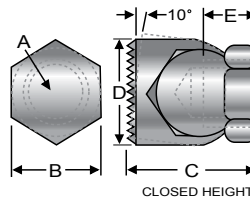

Steel Body, Serrated

Steel Body and Pad P/N	Thread (A)	Max Load (lbs)	Hex Size (B)	Closed Height (C)	Pad Dia. (D)	Thread Depth (E)
SSP-1	1/4-20	3,900	1/2	5/8	5/8	5/16
SSP-2	5/16-18	5,900	9/16	3/4	11/16	3/8
SSP-3	3/8-16	6,400	5/8	13/16	3/4	3/8
SSP-4	1/2-13	7,000	3/4	15/16	7/8	7/16
SSP-5	5/8-11	10,000	7/8	1	1	7/16
SSP-6	3/4-10	13,500	1 1/16	1 11/32	1 1/4	5/8
SSP-7	1-8	18,750	1 3/8	1 53/64	1 5/8	13/16

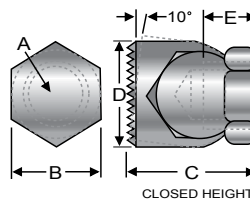

Stainless Steel Body, Serrated

Stainless Steel Body and Pad P/N	Thread (A)	Max Load (lbs)	Hex Size (B)	Closed Height (C)	Pad Dia. (D)	Thread Depth (E)
SSP-1S	1/4-20	5,000	1/2	5/8	5/8	5/16
SSP-2S	5/16-18	7,600	9/16	3/4	11/16	3/8
SSP-3S	3/8-16	8,250	5/8	13/16	3/4	3/8
SSP-4S	1/2-13	9,000	3/4	15/16	7/8	7/16
SSP-5S	5/8-11	12,900	7/8	1	1	7/16
SSP-6S	3/4-10	17,400	1 1/16	1 11/32	1 1/4	5/8
SSP-7S	1-8	24,200	1 3/8	1 53/64	1 5/8	13/16