



Spring Loaded Devices

Knurled Hand-Retractable Spring Plungers	88-89
L-Handle Hand-Retractable Spring Plungers	90-91
T-Handle Hand-Retractable Spring Plungers	92
Pull Ring Hand-Retractable Spring Plungers	93-96
Delrin® Knob Hand-Retractable Spring Plungers	97-98
Ball & Spring Plungers	99
Standard Spring Plunger	100-102
Short Spring Plunger	103-105
Ball Plunger	106-108
Press Fit Plunger	109-111

Hand Retractable Spring Plungers

S&W hand retractable spring plungers are precision machined from solid bar stock. The retractable plunger is hardened for greater side load strength in the extended position and is slightly tapered for easy alignment. All handle styles are easy to grip for fast, one-handed operation. With a 90° turn of the handle, the locking types will lock the plunger in the retracted position.

Hand retractable plungers have many industrial, medical and consumer applications and are commonly used as indexing, positioning and fastening components. Their quick disconnect and positive locking features are ideal for sports and recreational equipment.

Knurled Handle Style

The knurled knob is easy to grip and turn. Available as locking and non-locking and in yellow zinc plated steel, 303 stainless steel, 316 stainless steel and brass.



L-Handle Style

The L-shaped handle rotates 360° allowing it to be located out of the way in limited space applications. Available as locking and non-locking and in clear zinc plated steel, 303 stainless steel, 316 stainless steel and with a nylon nose.



Pull Ring Style

The convenient pull ring permits fast, one-finger operation. Available as locking and non-locking and in clear zinc plated steel, stainless steel and brass.



Delrin® Button Handle Style

The smooth appearance of this black Delrin® handle makes it ideal for consumer, food and medical applications. Available in black oxide or stainless steel as either a locking or non-locking nose.



T-Handle Style

The T-shaped handle makes this locking retractable plunger easy to grasp and turn. Available in zinc-plated steel or stainless.



Specifications:

Body, handle and plunger are steel, stainless steel or brass
 CNC machined from solid bar stock
 Steel plungers are hardened for extra side load strength
 10-32 to 1-8 threads (depending on style)
 Optional nylon patch for locking body into place



1-800-453-1692

www.aboveboardelectronics.com

Knurled Knob Locking Nose

Steel, Stainless Steel, and Brass
 Locking Hand-Retractable Knurled
 Handle Spring Plungers.

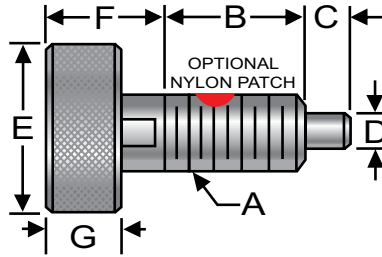

Locking Nose With Nylon Patch, Inch

Steel P/N	303 Stainless P/N	316 Stainless P/N	Brass P/N	Thread Size (A)	Thread Length (B)	Nose Length (C)	Nose Dia. (D)	Knob Dia. (E)	Knob/Hub Length (F)	Knurled Width (G)	End Force (lbs)	
											Start	Final
WKLS-0	SWKLS-0	SWKLS-0-316	BWKLS-0	10-32	0.40	0.09	0.104	3/8	1/4	3/16	0.5	3
WKLS-1	SWKLS-1	SWKLS-1-316	BWKLS-1	1/4-20	0.40	0.13	0.123	1/2	5/16	3/16	1	4
WKLS-2	SWKLS-2	SWKLS-2-316	BWKLS-2	5/16-18	0.63	0.19	0.154	5/8	3/8	1/4	1	5
WKLS-3	SWKLS-3	SWKLS-3-316	BWKLS-3	3/8-16	0.75	0.22	0.185	3/4	1/2	5/16	1	8
WKLS-4	SWKLS-4	SWKLS-4-316	BWKLS-4	1/2-13	0.88	0.25	0.248	1	5/8	3/8	1	10
WKLS-5	SWKLS-5	SWKLS-5-316	BWKLS-5	5/8-11	0.88	0.32	0.312	1-1/4	3/4	7/16	1.5	12
WKLS-6	SWKLS-6	SWKLS-6-316	BWKLS-6	3/4-10	1.20	0.45	0.375	1-1/2	13/16	1/2	1.5	16

Also available with nylon pellet.

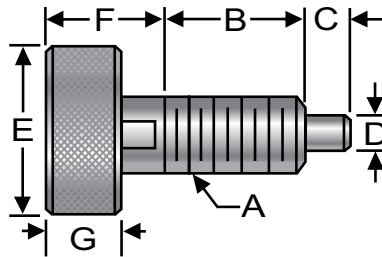

Locking Nose Without Nylon Patch, Inch

Steel P/N	303 Stainless P/N	316 Stainless P/N	Brass P/N	Thread Size (A)	Thread Length (B)	Nose Length (C)	Nose Dia. (D)	Knob Dia. (E)	Knob/Hub Length (F)	Knurled Width (G)	End Force (lbs)	
											Start	Final
KLS-0	SKLS-0	SKLS-0-316	BKLS-0	10-32	0.40	0.09	0.104	3/8	1/4	3/16	0.5	3
KLS-1	SKLS-1	SKLS-1-316	BKLS-1	1/4-20	0.40	0.13	0.123	1/2	5/16	3/16	1	4
KLS-2	SKLS-2	SKLS-2-316	BKLS-2	5/16-18	0.63	0.19	0.154	5/8	3/8	1/4	1	5
KLS-3	SKLS-3	SKLS-3-316	BKLS-3	3/8-16	0.75	0.22	0.185	3/4	1/2	5/16	1	8
KLS-4	SKLS-4	SKLS-4-316	BKLS-4	1/2-13	0.88	0.25	0.248	1	5/8	3/8	1	10
KLS-5	SKLS-5	SKLS-5-316	BKLS-5	5/8-11	0.88	0.32	0.312	1-1/4	3/4	7/16	1.5	12
KLS-6	SKLS-6	SKLS-6-316	BKLS-6	3/4-10	1.20	0.45	0.375	1-1/2	13/16	1/2	1.5	16



Request Info



1-800-453-1692

www.aboveboardelectronics.com

Knurled Knob Non-Locking

Steel, Stainless Steel, and Brass
Non-Locking Hand-Retractable
Knurled Handle Spring Plungers.

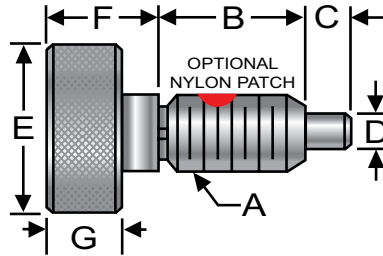

Non-locking Nose with Nylon Patch, Inch

Steel P/N	303 Stainless P/N	316 Stainless P/N	Brass P/N	Thread Size (A)	Thread Length (B)	Nose Length (C)	Nose Dia. (D)	Knob Dia. (E)	Knob/Hub Length (F)	Knurled Width (G)	End Force (lbs)	
											Start	Final
WKNL-0	SWKNL-0	SWKNL-0-316	BWKNL-0	10-32	0.40	0.09	0.104	3/8	1/4	3/16	0.5	3
WKNL-1	SWKNL-1	SWKNL-1-316	BWKNL-1	1/4-20	0.50	0.13	0.124	1/2	5/16	3/16	1	4
WKNL-2	SWKNL-2	SWKNL-2-316	BWKNL-2	5/16-18	0.63	0.19	0.155	5/8	3/8	1/4	1	6
WKNL-3	SWKNL-3	SWKNL-3-316	BWKNL-3	3/8-16	0.75	0.22	0.186	3/4	1/2	5/16	1	8
WKNL-4	SWKNL-4	SWKNL-4-316	BWKNL-4	1/2-13	0.88	0.25	0.249	1	5/8	3/8	1	10
WKNL-5	SWKNL-5	SWKNL-5-316	BWKNL-5	5/8-11	1.00	0.32	0.312	1-1/4	3/4	7/16	1.5	12
WKNL-6	SWKNL-6	SWKNL-6-316	BWKNL-6	3/4-10	1.20	0.45	0.375	1-1/2	13/16	1/2	1.5	16

Also available with nylon pellet.

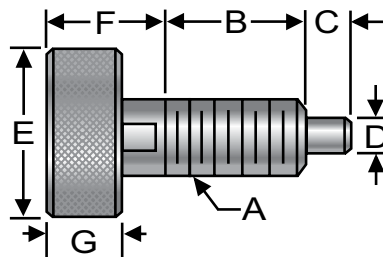

Non-locking Nose without Nylon Patch, Inch

Steel P/N	303 Stainless P/N	316 Stainless P/N	Brass P/N	Thread Size (A)	Thread Length (B)	Nose Length (C)	Nose Dia. (D)	Knob Dia. (E)	Knob/Hub Length (F)	Knurled Width (G)	End Force (lbs)	
											Start	Final
KNL-0	SKNL-0	SKNL-0-316	BKNL-0	10-32	0.40	0.09	0.104	3/8	1/4	3/16	0.5	3
KNL-1	SKNL-1	SKNL-1-316	BKNL-1	1/4-20	0.50	0.13	0.124	1/2	5/16	3/16	1	4
KNL-2	SKNL-2	SKNL-2-316	BKNL-2	5/16-18	0.63	0.19	0.155	5/8	3/8	1/4	1	6
KNL-3	SKNL-3	SKNL-3-316	BKNL-3	3/8-16	0.75	0.22	0.186	3/4	1/2	5/16	1	8
KNL-4	SKNL-4	SKNL-4-316	BKNL-4	1/2-13	0.88	0.25	0.249	1	5/8	3/8	1	10
KNL-5	SKNL-5	SKNL-5-316	BKNL-5	5/8-11	1.00	0.32	0.312	1-1/4	3/4	7/16	1.5	12
KNL-6	SKNL-6	SKNL-6-316	BKNL-6	3/4-10	1.20	0.45	0.375	1-1/2	13/16	1/2	1.5	16



Request Info



1-800-453-1692

www.aboveboardelectronics.com

L-Handle Locking Nose

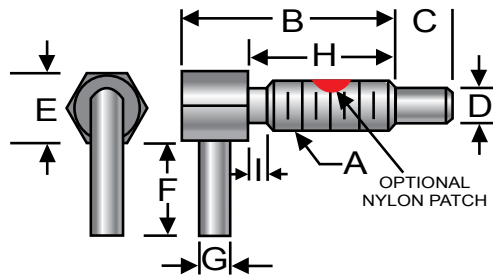

Locking Nose with Nylon Patch, Inch

Steel P/N	303 Stainless P/N	316 Stainless P/N	Thread Size (A)	Thread Length (H)	Body Length (B)	Nose Length (C)	Nose Dia. (D)	Hex Size (E)	Handle Length (F)	Handle Dia. (G)	Thread Relief (I)	End Force (lbs)	
												Start	Final
LLW-0	SLLW-0	SLLW-0-316	1/4-20	0.50	0.75	0.20	0.16	1/4	0.40	0.09	-	0.12	0.5
LLW-1	SLLW-1	SLLW-1-316	1/4-20	0.80	1.25	0.38	0.16	1/4	0.50	0.09	-	0.5	2.5
LLW-2	SLLW-2	SLLW-2-316	3/8-16	0.75	1.13	0.30	0.25	3/8	0.56	0.14	0.13	0.25	1.25
LLW-3	SLLW-3	SLLW-3-316	3/8-16	1.31	2.00	0.56	0.25	3/8	0.75	0.14	0.13	0.75	3.75
LLW-4	SLLW-4	SLLW-4-316	1/2-13	1.00	1.50	0.40	0.31	1/2	0.75	0.19	0.13	0.5	2
LLW-5	SLLW-5	SLLW-5-316	1/2-13	1.25	2.11	0.75	0.31	1/2	1.00	0.19	0.13	1	5
LLW-6	SLLW-6	SLLW-6-316	5/8-11	1.25	1.88	0.50	0.38	5/8	0.88	0.19	0.13	0.75	2.5
LLW-7	SLLW-7	SLLW-7-316	5/8-11	2.00	3.05	1.00	0.38	5/8	1.00	0.19	0.13	1	5

Also available with nylon pellet.

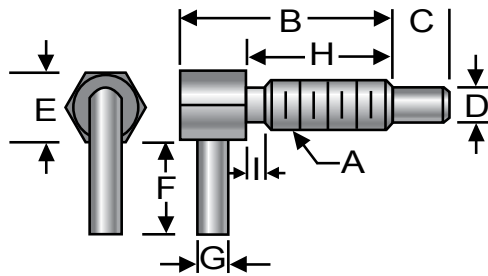

Locking Nose without Nylon Patch, Inch

Steel P/N	303 Stainless P/N	316 Stainless P/N	Thread Size (A)	Thread Length (H)	Body Length (B)	Nose Length (C)	Nose Dia. (D)	Hex Size (E)	Handle Length (F)	Handle Dia. (G)	Thread Relief (I)	End Force (lbs)	
												Start	Final
LL-0	LLS-0	LLS-0-316	1/4-20	0.50	0.75	0.20	0.16	1/4	0.40	0.09	-	0.12	0.5
LL-1	LLS-1	LLS-1-316	1/4-20	0.80	1.25	0.38	0.16	1/4	0.50	0.09	-	0.5	2.5
LL-2	LLS-2	LLS-2-316	3/8-16	0.75	1.13	0.30	0.25	3/8	0.56	0.14	0.13	0.25	1.25
LL-3	LLS-3	LLS-3-316	3/8-16	1.31	2.00	0.56	0.25	3/8	0.75	0.14	0.13	0.75	3.75
LL-4	LLS-4	LLS-4-316	1/2-13	1.00	1.50	0.40	0.31	1/2	0.75	0.19	0.13	0.5	2
LL-5	LLS-5	LLS-5-316	1/2-13	1.25	2.11	0.75	0.31	1/2	1.00	0.19	0.13	1	5
LL-6	LLS-6	LLS-6-316	5/8-11	1.25	1.88	0.50	0.38	5/8	0.88	0.19	0.13	0.75	2.5
LL-7	LLS-7	LLS-7-316	5/8-11	2.00	3.05	1.00	0.38	5/8	1.00	0.19	0.13	1	5



Request Info

1-800-453-1692

www.aboveboardelectronics.com

L-Handle Non-Locking Nose

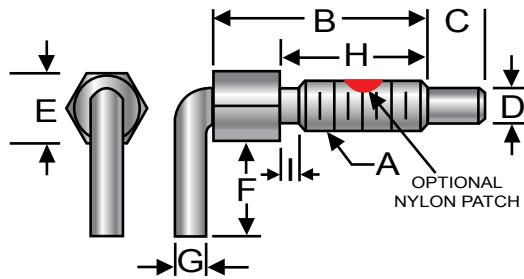

Non-Locking Nose with Nylon Patch, Inch

Steel P/N	303 Stainless P/N	Steel with Nylon Nose P/N	316 Stainless P/N	Thread Size (A)	Thread Length (H)	Body Length (B)	Nose Length (C)	Nose Dia. (D)	Hex Size (E)	Handle Length (F)	Handle Dia. (G)	Thread Relief (I)	End Force (lbs)	
													Start	Final
LNW-0	SLNW-0	NLNW-0	SLNW-0-316	1/4-20	0.50	0.75	0.20	0.16	1/4	0.40	0.09	-	0.12	0.5
LNW-1	SLNW-1	NLNW-1	SLNW-1-316	1/4-20	0.80	1.25	0.38	0.16	1/4	0.50	0.09	-	0.5	2.5
LNW-2	SLNW-2	NLNW-2	SLNW-2-316	3/8-16	0.75	1.13	0.30	0.25	3/8	0.56	0.14	0.13	0.25	1.25
LNW-3	SLNW-3	NLNW-3	SLNW-3-316	3/8-16	1.31	2.00	0.56	0.25	3/8	0.75	0.14	0.13	0.75	3.75
LNW-4	SLNW-4	NLNW-4	SLNW-4-316	1/2-13	1.00	1.50	0.40	0.31	1/2	0.75	0.19	0.13	0.5	2
LNW-5	SLNW-5	NLNW-5	SLNW-5-316	1/2-13	1.25	2.11	0.75	0.31	1/2	1.00	0.19	0.13	1	5
LNW-6	SLNW-6	NLNW-6	SLNW-6-316	5/8-11	1.25	1.88	0.50	0.38	5/8	0.88	0.19	0.13	0.75	2.5
LNW-7	SLNW-7	NLNW-7	SLNW-7-316	5/8-11	2.00	3.05	1.00	0.38	5/8	1.00	0.19	0.13	1	5

Also available with nylon pellet.

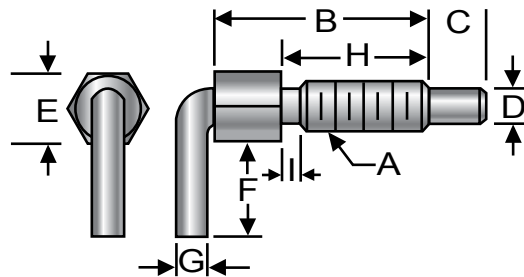

Non-Locking Nose without Nylon Patch, Inch

Steel P/N	303 Stainless P/N	Steel with Nylon Nose P/N	316 Stainless P/N	Thread Size (A)	Thread Length (H)	Body Length (B)	Nose Length (C)	Nose Dia. (D)	Hex Size (E)	Handle Length (F)	Handle Dia. (G)	Thread Relief (I)	End Force (lbs)	
													Start	Final
LN-0	LNS-0	NLN-0	LNS-0-316	1/4-20	0.50	0.75	0.20	0.16	1/4	0.40	0.09	-	0.12	0.5
LN-1	LNS-1	NLN-1	LNS-1-316	1/4-20	0.80	1.25	0.38	0.16	1/4	0.50	0.09	-	0.5	2.5
LN-2	LNS-2	NLN-2	LNS-2-316	3/8-16	0.75	1.13	0.30	0.25	3/8	0.56	0.14	0.13	0.25	1.25
LN-3	LNS-3	NLN-3	LNS-3-316	3/8-16	1.31	2.00	0.56	0.25	3/8	0.75	0.14	0.13	0.75	3.75
LN-4	LNS-4	NLN-4	LNS-4-316	1/2-13	1.00	1.50	0.40	0.31	1/2	0.75	0.19	0.13	0.5	2
LN-5	LNS-5	NLN-5	LNS-5-316	1/2-13	1.25	2.11	0.75	0.31	1/2	1.00	0.19	0.13	1	5
LN-6	LNS-6	NLN-6	LNS-6-316	5/8-11	1.25	1.88	0.50	0.38	5/8	0.88	0.19	0.13	0.75	2.5
LN-7	LNS-7	NLN-7	LNS-7-316	5/8-11	2.00	3.05	1.00	0.38	5/8	1.00	0.19	0.13	1	5

Pull Ring Locking Nose

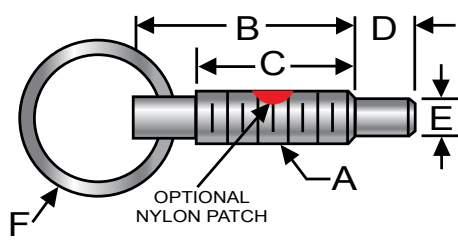

Standard Pull Ring Locking Nose with Nylon Patch, Inch

Steel P/N	303 Stainless P/N	Brass P/N	Thread Size (A)	Thread Length (C)	Body Length (B)	Nose Length (D)	Nose Dia. (E)	Ring Dia. (F)	End Force (lbs)	
									Start	Final
STPRW25	SSTPRW25	BSTPRW25	1/4-20	0.80	1.14	0.250	0.155	7/8	1	2.5
STPRW38	SSTPRW38	BSTPRW38	3/8-16	1.20	1.68	0.375	0.233	7/8	2	4
STPRW50	SSTPRW50	BSTPRW50	1/2-13	1.40	2.00	0.500	0.312	1	2.5	5
STPRW58	SSTPRW58	BSTPRW58	5/8-11	2.27	3.35	0.550	0.312	1 1/4	3	6
STPRW75	SSTPRW75	BSTPRW75	3/4-10	2.69	4.06	0.650	0.430	1 3/8	5	10
STPRW100	SSTPRW100	BSTPRW100	1-8	3.25	4.63	0.900	0.680	1 3/8	8	20

Also available with nylon pellet.

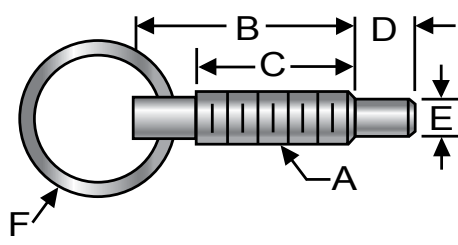

Locking Nose, Standard Pull Ring, without Nylon Patch, Inch

Steel P/N	303 Stainless P/N	Brass P/N	Thread Size (A)	Thread Length (C)	Body Length (B)	Nose Length (D)	Nose Dia. (E)	Ring Dia. (F)	End Force (lbs)	
									Start	Final
STPR25	SSTPR25	BSTPR25	1/4-20	0.80	1.14	0.250	0.155	7/8	1	2.5
STPR38	SSTPR38	BSTPR38	3/8-16	1.20	1.68	0.375	0.233	7/8	2	4
STPR50	SSTPR50	BSTPR50	1/2-13	1.40	2.00	0.500	0.312	1	2.5	5
STPR58	SSTPR58	BSTPR58	5/8-11	2.27	3.35	0.550	0.312	1 1/4	3	6
STPR75	SSTPR75	BSTPR75	3/4-10	2.69	4.06	0.650	0.430	1 3/8	5	10
STPR100	SSTPR100	BSTPR100	1-8	3.25	4.63	0.900	0.680	1 3/8	8	20



Request Info

1-800-453-1692

www.aboveboardelectronics.com

Pull-Ring Handle Non-Locking Nose

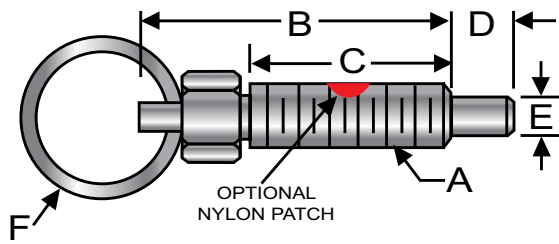

Non-Locking Nose, Standard Pull Ring, with Nylon Patch, Inch

Steel P/N	303 Stainless P/N	Brass P/N	Thread Size (A)	Thread Length (C)	Body Length (B)	Nose Length (D)	Nose Dia. (E)	Ring Dia. (F)	End Force (lbs)	
									Start	Final
NSTPRW25	NSSTPRW25	BNSTPRW25	1/4-20	1.14	0.80	0.250	0.155	7/8	1	2.5
NSTPRW38	NSSTPRW38	BNSTPRW38	3/8-16	1.68	1.20	0.375	0.233	7/8	2	4
NSTPRW50	NSSTPRW50	BNSTPRW50	1/2-13	2.00	1.40	0.500	0.312	1	2.5	5
NSTPRW58	NSSTPRW58	BNSTPRW58	5/8-11	3.35	2.27	0.550	0.312	1 1/4	3	6
NSTPRW75	NSSTPRW75	BNSTPRW75	3/4-10	4.06	2.69	0.650	0.430	1 3/8	5	10
NSTPRW100	NSSTPRW100	BNSTPRW100	1-8	4.63	3.25	0.900	0.680	1 3/8	8	20

Also available with nylon pellet.

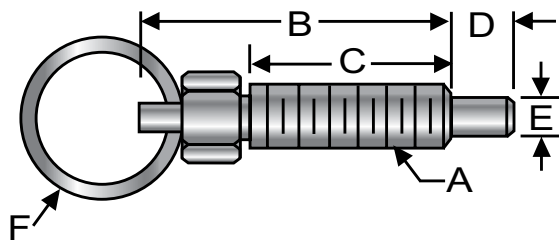

Standard Pull Ring Non-Locking Nose without Nylon Patch, Inch

Steel P/N	303 Stainless P/N	Brass P/N	Thread Size (A)	Thread Length (C)	Body Length (B)	Nose Length (D)	Nose Dia. (E)	Ring Dia. (F)	End Force (lbs)	
									Start	Final
NSTPR25	NSSTPR25	BNSTPR25	1/4-20	1.14	0.80	0.250	0.155	7/8	1	2.5
NSTPR38	NSSTPR38	BNSTPR38	3/8-16	1.68	1.20	0.375	0.233	7/8	2	4
NSTPR50	NSSTPR50	BNSTPR50	1/2-13	2.00	1.40	0.500	0.312	1	2.5	5
NSTPR58	NSSTPR58	BNSTPR58	5/8-11	3.35	2.27	0.550	0.312	1 1/4	3	6
NSTPR75	NSSTPR75	BNSTPR75	3/4-10	4.06	2.69	0.650	0.430	1 3/8	5	10
NSTPR100	NSSTPR100	BNSTPR100	1-8	4.63	3.25	0.900	0.680	1 3/8	8	20



Request Info



1-800-453-1692

www.aboveboardelectronics.com

Stubby Pull Ring Non-Locking Nose

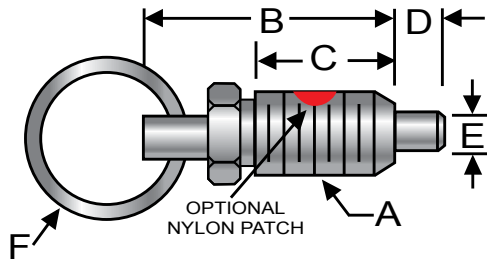

Stubby Pull Ring Non-Locking Nose with Nylon Patch, Inch

Steel P/N	303 Stainless P/N	Brass P/N	Thread Size (A)	Thread Length (C)	Body Length (B)	Nose Length (D)	Nose Dia. (E)	Ring Dia. (F)	End Force (lbs)	
									Start	Final
PRW25	SPRW25	BPRW25	1/4-20	0.31	0.57	0.19	0.160	3/4	0.5	2
PRW38	SPRW38	BPRW38	3/8-16	0.44	0.82	0.28	0.250	3/4	0.75	3
PRW50	SPRW50	BPRW50	1/2-13	0.56	1.06	0.38	0.310	1	1	4
PRW58	SPRW58	BPRW58	5/8-11	0.69	1.31	0.44	0.380	1	1.25	5
PRW75	SPRW75	BPRW75	3/4-10	0.88	1.50	0.50	0.437	1 1/8	1.5	6
PRW100	SPRW100	BPRW100	1-8	1.00	1.75	0.63	0.500	1 1/8	1.75	7

Also available with nylon pellet.

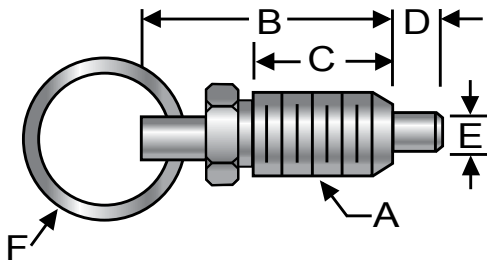

Stubby Pull Ring Non-Locking Nose without Nylon Patch, Inch

Steel P/N	303 Stainless P/N	Brass P/N	Thread Size (A)	Thread Length (C)	Body Length (B)	Nose Length (D)	Nose Dia. (E)	Ring Dia. (F)	End Force (lbs)	
									Start	Final
PR25	SPR25	BPR25	1/4-20	0.31	0.57	0.19	0.160	3/4	0.5	2
PR38	SPR38	BPR38	3/8-16	0.44	0.82	0.28	0.250	3/4	0.75	3
PR50	SPR50	BPR50	1/2-13	0.56	1.06	0.38	0.310	1	1	4
PR58	SPR58	BPR58	5/8-11	0.69	1.31	0.44	0.380	1	1.25	5
PR75	SPR75	BPR75	3/4-10	0.88	1.50	0.50	0.437	1 1/8	1.5	6
PR100	SPR100	BPR100	1-8	1.00	1.75	0.63	0.500	1 1/8	1.75	7



Request Info

1-800-453-1692
www.aboveboardelectronics.com

Stubby Pull Ring Non-Locking Nose

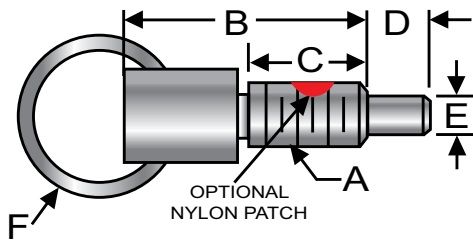

Stubby Pull Ring Locking Nose with Nylon Patch, Inch

Steel P/N	303 Stainless P/N	316 Stainless P/N	Brass P/N	Thread Size (A)	Thread Length (C)	Body Length (B)	Nose Length (D)	Nose Dia. (E)	Ring Dia. (F)	End Force (lbs)	
										Start	Final
LPRW25	SLPRW25	SLPRW25-316	BLPRW25	1/4-20	0.57	0.31	0.19	0.160	3/4	0.5	2
LPRW38	SLPRW38	SLPRW38-316	BLPRW38	3/8-16	0.82	0.44	0.28	0.250	3/4	0.75	3
LPRW50	SLPRW50	SLPRW50-316	BLPRW50	1/2-13	1.06	0.56	0.38	0.310	1	1	4
LPRW58	SLPRW58	SLPRW58-316	BLPRW58	5/8-11	1.31	0.69	0.44	0.380	1	1.25	5
LPRW75	SLPRW75	SLPRW75-316	BLPRW75	3/4-10	1.50	0.88	0.50	0.437	1 1/8	1.5	6
LPRW100	SLPRW100	SLPRW100-316	BLPRW100	1-8	1.75	1.00	0.63	0.500	1 1/8	1.75	7

Also available with nylon pellet.

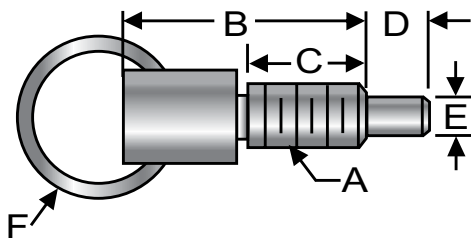

Stubby Pull Ring Locking Nose without Nylon Patch, Inch

Steel P/N	303 Stainless P/N	316 Stainless P/N	Brass P/N	Thread Size (A)	Thread Length (C)	Body Length (B)	Nose Length (D)	Nose Dia. (E)	Ring Dia. (F)	End Force (lbs)	
										Start	Final
LPR25	SLPR25	SLPR25-316	BLPR25	1/4-20	0.57	0.31	0.19	0.160	3/4	0.5	2
LPR38	SLPR38	SLPR38-316	BLPR38	3/8-16	0.82	0.44	0.28	0.250	3/4	0.75	3
LPR50	SLPR50	SLPR50-316	BLPR50	1/2-13	1.06	0.56	0.38	0.310	1	1	4
LPR58	SLPR58	SLPR58-316	BLPR58	5/8-11	1.31	0.69	0.44	0.380	1	1.25	5
LPR75	SLPR75	SLPR75-316	BLPR75	3/4-10	1.50	0.88	0.50	0.437	1 1/8	1.5	6
LPR100	SLPR100	SLPR100-316	BLPR100	1-8	1.75	1.00	0.63	0.500	1 1/8	1.75	7

Delrin® Handle Locking Nose

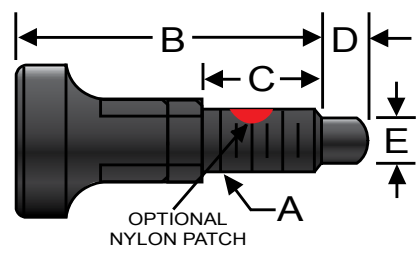

Locking Nose with Nylon Patch, Inch

Steel P/N	303 Stainless P/N	Thread Size (A)	Thread Length (C)	Body Length (B)	Nose Length (D)	Nose Dia. (E)	End Force (lbs)	
							Start	Final
DKLW25	SDKLW25	1/4-20	0.63	0.97	0.13	0.16	0.12	0.36
DKLW38	SDKLW38	3/8-16	0.75	1.40	0.18	0.25	0.25	2.0
DKLW50	SDKLW50	1/2-13	1.00	1.90	0.25	0.31	0.50	1.75

Also available with nylon pellet.

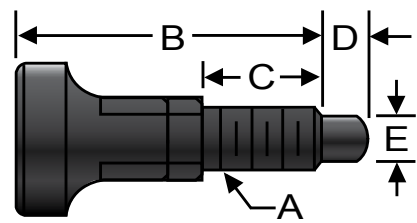

Locking Nose without Nylon Patch, Inch

Steel P/N	303 Stainless P/N	Thread Size (A)	Thread Length (C)	Body Length (B)	Nose Length (D)	Nose Dia. (E)	End Force (lbs)	
							Start	Final
DKL25	SDKL25	1/4-20	0.63	0.97	0.13	0.16	0.12	0.36
DKL38	SDKL38	3/8-16	0.75	1.40	0.18	0.25	0.25	2.0
DKL50	SDKL50	1/2-13	1.00	1.90	0.25	0.31	0.50	1.75



Request Info

1-800-453-1692
www.aboveboardelectronics.com

Delrin® Handle Non-Locking Nose

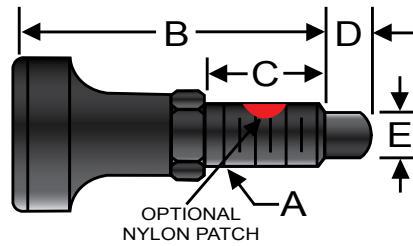

Non-Locking Nose with Nylon Patch, Inch

Steel P/N	303 Stainless P/N	Thread Size (A)	Thread Length (C)	Body Length (B)	Nose Length (D)	Nose Dia. (E)	End Force (lbs)	
							Start	Final
DKNW25	SDKNW25	1/4-20	0.63	0.97	0.13	0.16	0.12	0.36
DKNW38	SDKNW38	3/8-16	0.75	1.40	0.18	0.25	0.25	2.0
DKNW50	SDKNW50	1/2-13	1.00	1.90	0.25	0.31	0.50	1.75

Also available with nylon pellet.

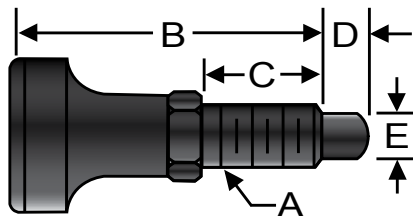

Non-Locking Nose without Nylon Patch, Inch

Steel P/N	303 Stainless P/N	Thread Size (A)	Thread Length (C)	Body Length (B)	Nose Length (D)	Nose Dia. (E)	End Force (lbs)	
							Start	Final
DKN25	SDKN25	1/4-20	0.63	0.97	0.13	0.16	0.12	0.36
DKN38	SDKN38	3/8-16	0.75	1.40	0.18	0.25	0.25	2.0
DKN50	SDKN50	1/2-13	1.00	1.90	0.25	0.31	0.50	1.75

T-Handle Locking Nose

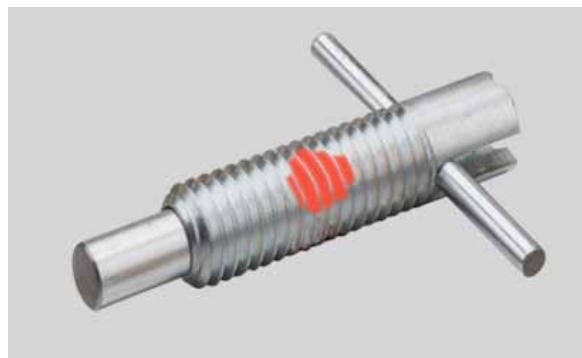
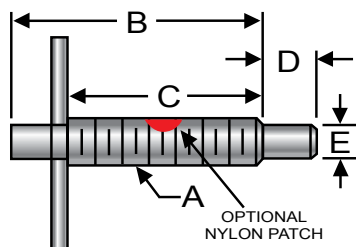

T-Handle with Patch

Steel P/N	Stainless P/N	Thread Size (A)	Body Length (B)	Thread Length (C)	Nose Length (D)	Nose Dia. (E)	End Force (lbs)	
							Start	Final
THW25	STHW25	1/4-20	1.14	0.80	0.25	0.155	1.0	2.5
THW38	STHW25	3/8-16	1.68	1.20	0.38	0.233	2.0	4.0
THW50	STHW25	1/2-13	2.00	1.40	0.50	0.312	2.5	5.0
THW58	STHW25	5/8-11	2.38	1.70	0.63	0.375	2.5	5.0

Also available with nylon pellet.

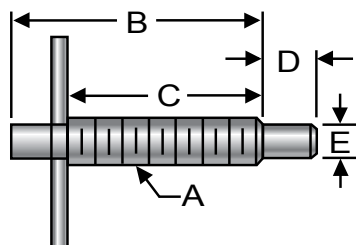

T-Handle without Patch

Steel P/N	Stainless P/N	Thread Size (A)	Body Length (B)	Thread Length (C)	Nose Length (D)	Nose Dia. (E)	End Force (lbs)	
							Start	Final
TH25	STH25	1/4-20	1.14	0.80	0.25	0.155	1.0	2.5
TH38	STH38	3/8-16	1.68	1.20	0.38	0.233	2.0	4.0
TH50	STH50	1/2-13	2.00	1.40	0.50	0.312	2.5	5.0
TH58	STH58	5/8-11	2.38	1.70	0.63	0.375	2.5	5.0

Ball & Spring Plungers

S&W Spring and Ball Plungers are devices that enclose a spring in a threaded capsule and provide a means of applying accurate and repeatable spring end forces through a ball or rounded nose. Also known as Spring Loaded Devices (SLDs), the unique features of ball and spring plungers make them essential components in thousands of applications for indexing, positioning, fixturing, latching, locking, ejecting, electrical contacts and many others.

Encapsulating the spring inside the body has several advantages over standard, unprotected springs: installation is fast and easy, side forces can be applied to the assembly and repeatable end forces and extension are maintained throughout the life of the plunger.

Most installations can be done with a screwdriver, but care must be taken since the body is hollow and does not have the strength of a bolt or screw.

Standard Spring Plunger

These plungers combine positive, controlled spring pressure with a long-travel plunger. Used extensively in fixtures, dies and assemblies. Available in black oxide or stainless steel with a hardened steel or nylon plunger. Also available in 316 stainless and brass.



Short Spring Plunger

These plungers have the same design as standard spring plungers, but the shorter body and slightly shorter travel make it ideal for use where space is limited. Available in black oxide or stainless steel with a hardened steel or nylon plunger. Also available in 316 stainless and brass.



Ball Plunger

This compact plunger is used in positioning, indexing and retention applications. The controlled and repeatable spring pressure ensures reliable, consistent operation. Available with a steel or stainless steel body and a hardened chrome steel or stainless steel ball. Also available in 316 stainless and brass.



Press Fit Ball Plunger

Press Fit ball plungers are made from high-grade stainless and black oxide plated steel. They are available in sizes ranging from 1/8" to 1/2". The ball, either steel or nylon, is crimped into the hollow tube for a fit that gives, but doesn't give up.



Standard Spring Plunger Standard End Force Steel & Stainless Steel

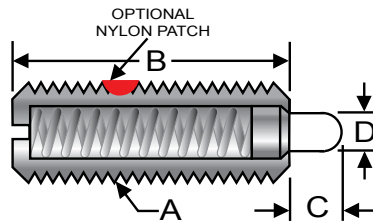

Standard End Force, Inch

Steel Nose P/N	Nylon Nose P/N	Thread (A)	Body Length (B)	Nose Length (C)	Nose Dia. (D)	End Force (lbs)	
						Start	Final
SW10-1X	-	6-32	3/8	1/16	0.045	1	1.6
SW10-1	-	6-32	17/32	1/16	0.045	1.5	4.5
SW10-2	SWN10-2	8-32	5/8	3/32	0.069	2.7	7.3
SW10-3	SWN10-3	10-32	3/4	1/8	0.092	2.9	11.1
SW10-4X	-	1/4-20	3/4	1/8	0.118	2	9
SW10-4	SWN10-4	1/4-20	1	3/16	0.118	3	13
SW10-4Y	SWN10-4Y	1/4-28	1	3/16	0.118	3	13
SW10-5	SWN10-5	5/16-18	1	3/16	0.134	3	15
SW10-6	SWN10-6	3/8-16	1-1/8	3/16	0.186	5.5	14.5
SW10-8	SWN10-8	1/2-13	1-1/4	1/4	0.248	6.6	17.4
SW10-10	SWN10-10	5/8-11	1-1/2	5/16	0.311	10.5	25.5
SW10-12	-	3/4-10	1-3/4	5/16	0.373	6.7	37.3
SW10-14	-	1-8	2-13/32	1/2	0.498	16	68

Add "P" to end of part number for optional nylon patch. Do not use the nylon patch if threading into soft material such as aluminum.
Add "PT" for nylon pellet.

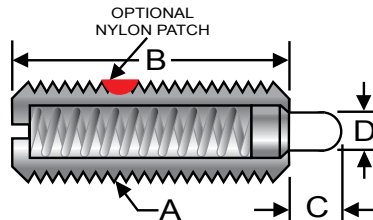

Stainless-Standard End Force, Inch

303 Stainless P/N	303 Stainless Nylon Nose P/N	Thread (A)	Body Length (B)	Nose Length (C)	Nose Dia. (D)	End Force (lbs)	
						Start	Final
SSW10-1X	-	6-32	3/8	1/16	0.045	1	1.6
SSW10-1	-	6-32	17/32	1/16	0.045	1.5	4.5
SSW10-2	SSWN10-2	8-32	5/8	3/32	0.069	2.7	7.3
SSW10-3	SSWN10-3	10-32	3/4	1/8	0.092	2.9	11.1
SSW10-4X	-	1/4-20	3/4	1/8	0.118	2	9
SSW10-4	SSWN10-4	1/4-20	1	3/16	0.118	3	13
SSW10-4Y	SSWN10-4Y	1/4-28	1	3/16	0.118	3	13
SSW10-5	SSWN10-5	5/16-18	1	3/16	0.134	3	15
SSW10-6	SSWN10-6	3/8-16	1-1/8	3/16	0.186	5.5	14.5
SSW10-8	SSWN10-8	1/2-13	1-1/4	1/4	0.248	6.6	17.4
SSW10-10	SSWN10-10	5/8-11	1-1/2	5/16	0.311	10.5	25.5
SSW10-12	-	3/4-10	1-3/4	5/16	0.373	6.7	37.3
SSW10-14	-	1-8	2-13/32	1/2	0.498	16	68

Add "P" to end of part number for optional nylon patch. Do not use the nylon patch if threading into soft material such as aluminum.
Add "PT" for nylon pellet.



Request Info

1-800-453-1692
www.aboveboardelectronics.com

Standard Spring Plunger Light End Force Steel & Stainless Steel

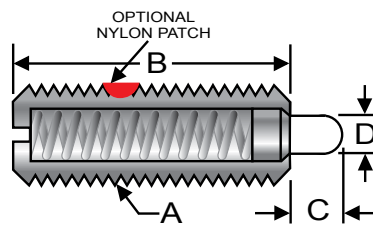

Light End Force, Inch

Steel Nose P/N	Nylon Nose P/N	Thread (A)	Body Length (B)	Nose Length (C)	Nose Dia. (D)	End Force (lbs)	
						Start	Final
SW10-1A	-	6-32	17/32	1/16	0.045	0.5	1.5
SW10-2A	SWN10-2A	8-32	5/8	3/32	0.069	0.7	2.3
SW10-3A	SWN10-3A	10-32	3/4	1/8	0.092	1.3	2.7
SW10-4XA	-	1/4-20	3/4	1/8	0.118	0.5	2
SW10-4A	SWN10-4A	1/4-20	1	3/16	0.118	1	4
SW10-4YA	SWN10-4YA	1/4-28	1	3/16	0.118	1	4
SW10-5A	SWN10-5A	5/16-18	1	3/16	0.134	1.5	4.5
SW10-6A	SWN10-6A	3/8-16	1-1/8	3/16	0.186	2.8	7.2
SW10-8A	SWN10-8A	1/2-13	1-1/4	1/4	0.248	2.7	9.3
SW10-10A	SWN10-10A	5/8-11	1-1/2	5/16	0.311	3.5	10.5
SW10-12A	-	3/4-10	1-3/4	5/16	0.373	6	16
SW10-14A	-	1-8	2-13/32	1/2	0.498	4	31

Add "P" to end of part number for optional nylon patch. Do not use the nylon patch if threading into soft material such as aluminum.
Add "PT" for nylon pellet.

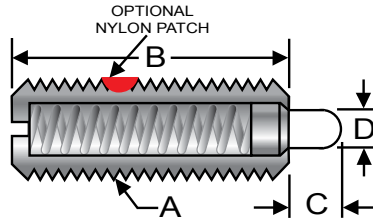

Stainless-Light End Force, Inch

303 Stainless P/N	303 Stainless Nylon Nose P/N	Thread (A)	Body Length (B)	Nose Length (C)	Nose Dia. (D)	End Force (lbs)	
						Start	Final
SSW10-1A	-	6-32	17/32	1/16	0.045	0.5	1.5
SSW10-2A	SSWN10-2A	8-32	5/8	3/32	0.069	0.7	2.3
SSW10-3A	SSWN10-3A	10-32	3/4	1/8	0.092	1.3	2.7
SSW10-4XA	-	1/4-20	3/4	1/8	0.118	0.5	2
SSW10-4A	SSWN10-4A	1/4-20	1	3/16	0.118	1	4
SSW10-4YA	SSWN10-4YA	1/4-28	1	3/16	0.118	1	4
SSW10-5A	SSWN10-5A	5/16-18	1	3/16	0.134	1.5	4.5
SSW10-6A	SSWN10-6A	3/8-16	1-1/8	3/16	0.186	2.8	7.2
SSW10-8A	SSWN10-8A	1/2-13	1-1/4	1/4	0.248	2.7	9.3
SSW10-10A	SSWN10-10A	5/8-11	1-1/2	5/16	0.311	3.5	10.5
SSW10-12A	-	3/4-10	1-3/4	5/16	0.373	6	16
SSW10-14A	-	1-8	2-13/32	1/2	0.498	4	31

Add "P" to end of part number for optional nylon patch. Do not use the nylon patch if threading into soft material such as aluminum.
Add "PT" for nylon pellet.

Standard Spring Plunger Standard End Force Brass & 316 Stainless Steel

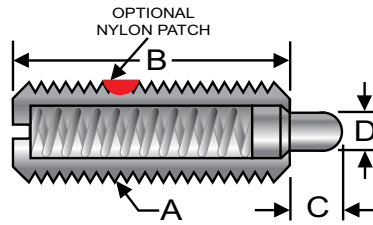

Standard End Force, Inch

Brass P/N	316 Stainless P/N	Thread (A)	Body Length (B)	Nose Length (C)	Nose Dia. (D)	End Force (lbs)	
						Start	Final
SWB10-1X	SSW10-1X-316	6-32	3/8	1/16	0.045	1	1.6
SWB10-1	SSW10-1-316	6-32	17/32	1/16	0.045	1.5	4.5
SWB10-2	SSW10-2-316	8-32	5/8	3/32	0.069	2.7	7.3
SWB10-3	SSW10-3-316	10-32	3/4	1/8	0.092	2.9	11.1
SWB10-4X	SSW10-4X-316	1/4-20	3/4	1/8	0.118	2	9
SWB10-4	SSW10-4-316	1/4-20	1	3/16	0.118	3	13
SWB10-4Y	SSW10-4Y-316	1/4-28	1	3/16	0.118	3	13
SWB10-5	SSW10-5-316	5/16-18	1	3/16	0.134	3	15
SWB10-6	SSW10-6-316	3/8-16	1-1/8	3/16	0.186	5.5	14.5
SWB10-8	SSW10-8-316	1/2-13	1-1/4	1/4	0.248	6.6	17.4
SWB10-10	SSW10-10-316	5/8-11	1-1/2	5/16	0.311	10.5	25.5
SWB10-12	SSW10-12-316	3/4-10	1-3/4	5/16	0.373	6.7	37.3
SWB10-14	SSW10-14-316	1-8	2-13/32	1/2	0.498	16	68

Add "P" to end of part number for optional nylon patch. Do not use the nylon patch if threading into soft material such as aluminum.
Add "PT" for nylon pellet.

Standard Spring Plunger Light End Force Brass & 316 Stainless Steel

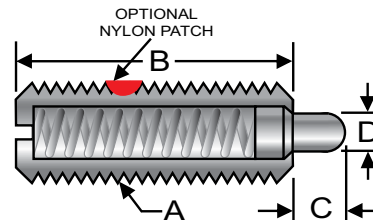

Light End Force, Inch

Brass P/N	316 Stainless P/N	Thread (A)	Body Length (B)	Nose Length (C)	Nose Dia. (D)	End Force (lbs)	
						Start	Final
SWB10-1A	SSW10-1A-316	6-32	17/32	1/16	0.045	0.5	1.5
SWB10-2A	SSW10-2A-316	8-32	5/8	3/32	0.069	0.7	2.3
SWB10-3A	SSW10-3A-316	10-32	3/4	1/8	0.092	1.3	2.7
SWB10-4XA	SSW10-4XA-316	1/4-20	3/4	1/8	0.118	0.5	2
SWB10-4A	SSW10-4A-316	1/4-20	1	3/16	0.118	1	4
SWB10-4YA	SSW10-4YA-316	1/4-28	1	3/16	0.118	1	4
SWB10-5A	SSW10-5A-316	5/16-18	1	3/16	0.134	1.5	4.5
SWB10-6A	SSW10-6A-316	3/8-16	1-1/8	3/16	0.186	2.8	7.2
SWB10-8A	SSW10-8A-316	1/2-13	1-1/4	1/4	0.248	2.7	9.3
SWB10-10A	SSW10-10A-316	5/8-11	1-1/2	5/16	0.311	3.5	10.5
SWB10-12A	SSW10-12A-316	3/4-10	1-3/4	5/16	0.373	6	16
SWB10-14A	SSW10-14A-316	1-8	2-13/32	1/2	0.498	4	31

Add "P" to end of part number for optional nylon patch. Do not use the nylon patch if threading into soft material such as aluminum.
Add "PT" for nylon pellet.



Request Info
1-800-453-1692
www.aboveboardelectronics.com

Short Spring Plunger Standard End Force

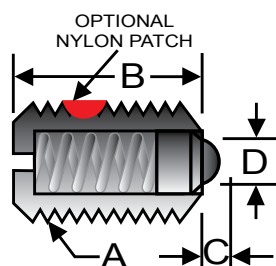

Steel-Standard End Force, Inch

Steel Nose P/N	Nylon Nose P/N	Thread (A)	Body Length (B)	Nose Length (C)	Nose Dia. (D)	End Force (lbs)	
						Start	Final
SW10-2AS	SWN10-2AS	8-32	0.437	0.052	0.070	1.5	4.7
SW10-2S	SWN10-2S	8-36	0.437	0.052	0.070	1.5	4.7
SW10-3S	SWN10-3S	10-32	0.468	0.065	0.093	1.7	6.2
SW10-4S	SWN10-4S	1/4-20	0.531	0.078	0.119	3	10.5
SW10-5S	SWN10-5S	5/16-18	0.562	0.084	0.135	3.7	15.5
SW10-6S	SWN10-6S	3/8-16	0.625	0.110	0.186	4.5	18.5
SW10-8S	SWN10-8S	1/2-13	0.750	0.151	0.248	5	28.5
SW10-10S	SWN10-10S	5/8-11	1.062	0.215	0.310	7	50

Add "P" to end of part number for optional nylon patch. Do not use the nylon patch if threading into soft material such as aluminum. Add "PT" for nylon pellet.

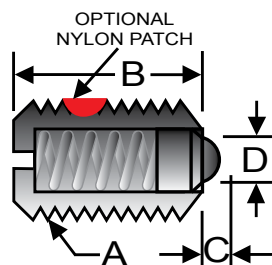

303 Stainless Steel -Standard End Force, Inch

Stainless Nose P/N	Nylon Nose P/N	Thread (A)	Body Length (B)	Nose Length (C)	Nose Dia. (D)	End Force (lbs)	
						Start	Final
SSW10-2AS	SSWN10-2AS	8-32	0.437	0.052	0.070	1.5	4.7
SSW10-2S	SSWN10-2S	8-36	0.437	0.052	0.070	1.5	4.7
SSW10-3S	SSWN10-3S	10-32	0.468	0.065	0.093	1.7	6.2
SSW10-4S	SSWN10-4S	1/4-20	0.531	0.078	0.119	3	10.5
SSW10-5S	SSWN10-5S	5/16-18	0.562	0.084	0.135	3.7	15.5
SSW10-6S	SSWN10-6S	3/8-16	0.625	0.110	0.186	4.5	18.5
SSW10-8S	SSWN10-8S	1/2-13	0.750	0.151	0.248	5	28.5
SSW10-10S	SSWN10-10S	5/8-11	1.062	0.215	0.310	7	50

Add "P" to end of part number for optional nylon patch. Do not use the nylon patch if threading into soft material such as aluminum. Add "PT" for nylon pellet.

Short Spring Plunger Light End Force Steel & Stainless Steel

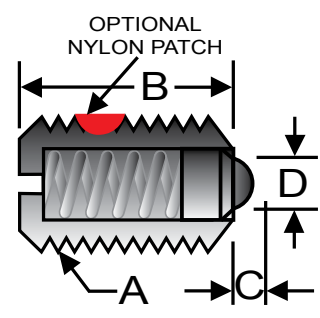

Steel -Light End Force, Inch

Steel Nose P/N	Nylon Nose P/N	Thread (A)	Body Length (B)	Nose Length (C)	Nose Dia. (D)	End Force (lbs)	
						Start	Final
SW10-2ASL	SWN10-2ASL	8-32	0.437	0.052	0.070	0.50	1.5
SW10-2SL	SWN10-2SL	8-36	0.437	0.052	0.070	0.50	1.5
SW10-3SL	SWN10-3SL	10-32	0.468	0.065	0.093	0.75	2.5
SW10-4SL	SWN10-4SL	1/4-20	0.531	0.078	0.119	1.0	3.5
SW10-5SL	SWN10-5SL	5/16-18	0.562	0.084	0.135	1.25	4.0
SW10-6SL	SWN10-6SL	3/8-16	0.625	0.110	0.186	1.5	5.0
SW10-8SL	SWN10-8SL	1/2-13	0.750	0.151	0.248	1.75	5.5
SW10-10SL	SWN10-10SL	5/8-11	1.062	0.215	0.310	2.0	8.5

Add "P" to end of part number for optional nylon patch. Do not use the nylon patch if threading into soft material such as aluminum.
Add "PT" for nylon pellet.

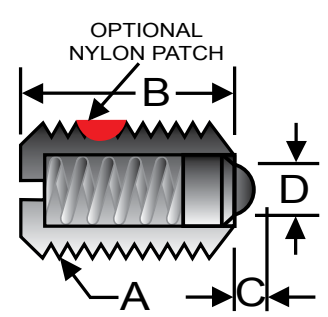

303 Stainless Steel -Light End Force, Inch

Stainless Nose P/N	Nylon Nose P/N	Thread (A)	Body Length (B)	Nose Length (C)	Nose Dia. (D)	End Force (lbs)	
						Start	Final
SSW10-2ASL	SSWN10-2ASL	8-32	0.437	0.052	0.070	0.50	1.5
SSW10-2SL	SSWN10-2SL	8-36	0.437	0.052	0.070	0.50	1.5
SSW10-3SL	SSWN10-3SL	10-32	0.468	0.065	0.093	0.75	2.5
SSW10-4SL	SSWN10-4SL	1/4-20	0.531	0.078	0.119	1.0	3.5
SSW10-5SL	SSWN10-5SL	5/16-18	0.562	0.084	0.135	1.25	4.0
SSW10-6SL	SSWN10-6SL	3/8-16	0.625	0.110	0.186	1.5	5.0
SSW10-8SL	SSWN10-8SL	1/2-13	0.750	0.151	0.248	1.75	5.5
SSW10-10SL	SSWN10-10SL	5/8-11	1.062	0.215	0.310	2.0	8.5

Add "P" to end of part number for optional nylon patch. Do not use the nylon patch if threading into soft material such as aluminum.
Add "PT" for nylon pellet.

Short Spring Plunger

Brass & 316 Stainless

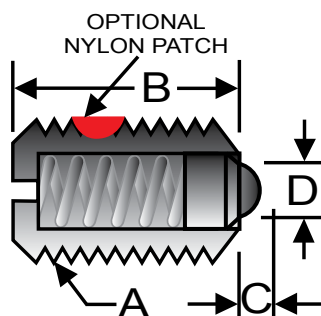

Standard End Force, Inch

Brass P/N	316 Stainless P/N	Thread (A)	Body Length (B)	Nose Length (C)	Nose Dia. (D)	End Force (lbs)	
						Start	Final
SWB10-2AS	SSW10-2AS-316	8-32	0.437	0.052	0.070	1.5	4.7
SWB10-2S	SSW10-2S-316	8-36	0.437	0.052	0.070	1.5	4.7
SWB10-3S	SSW10-3S-316	10-32	0.468	0.065	0.093	1.7	6.2
SWB10-4S	SSW10-4S-316	1/4-20	0.531	0.078	0.119	3.0	10.5
SWB10-5S	SSW10-5S-316	5/16-18	0.562	0.084	0.135	3.7	15.5
SWB10-6S	SSW10-6S-316	3/8-16	0.625	0.110	0.186	4.5	18.5
SWB10-8S	SSW10-8S-316	1/2-13	0.750	0.151	0.248	5.0	28.5
SWB10-10S	SSW10-10S-316	5/8-11	1.062	0.215	0.310	7.0	50.0

Add "P" to end of part number for optional nylon patch. Do not use the nylon patch if threading into soft material such as aluminum.
Add "PT" for nylon pellet.

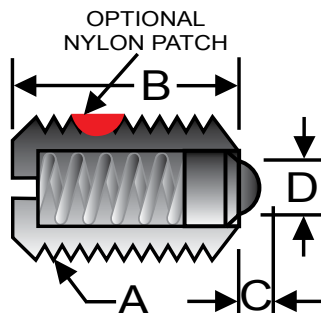

Light End Force, Inch

Brass P/N	316 Stainless P/N	Thread (A)	Body Length (B)	Nose Length (C)	Nose Dia. (D)	End Force (lbs)	
						Start	Final
SWB10-2ASL	SSW10-2ASL-316	8-32	0.437	0.052	0.070	0.50	1.5
SWB10-2SL	SSW10-2SL-316	8-36	0.437	0.052	0.070	0.50	1.5
SWB10-3SL	SSW10-3SL-316	10-32	0.468	0.065	0.093	0.75	2.5
SWB10-4SL	SSW10-4SL-316	1/4-20	0.531	0.078	0.119	1.0	3.5
SWB10-5SL	SSW10-5SL-316	5/16-18	0.562	0.084	0.135	1.25	4.0
SWB10-6SL	SSW10-6SL-316	3/8-16	0.625	0.110	0.186	1.5	5.0
SWB10-8SL	SSW10-8SL-316	1/2-13	0.750	0.151	0.248	1.75	5.5
SWB10-10SL	SSW10-10SL-316	5/8-11	1.062	0.215	0.310	2.0	8.5

Add "P" to end of part number for optional nylon patch. Do not use the nylon patch if threading into soft material such as aluminum.
Add "PT" for nylon pellet.

Ball Plunger Steel

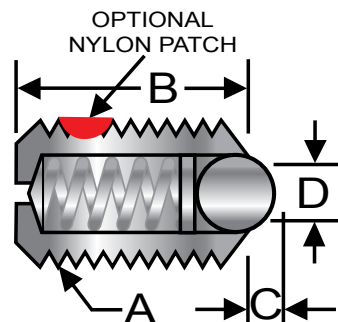

Steel, Inch

Steel Nose P/N	Nylon Nose P/N	Thread (A)	Body Length (B)	Exposed Length (C)	Ball Dia. (D)	End Force (lbs)	
						Start	Final
SW10-11B	SWN10-11B	4-48	0.187	0.020	0.062	0.125	0.5
SW10-12B	SWN10-12B	5-40	0.250	0.020	0.062	0.25	0.75
SW10-1B	SWN10-1B	6-40	0.312	0.023	0.078	0.5	1.0
SW10-22B	SWN10-22B	8-32	0.344	0.025	0.094	0.5	1.25
SW10-2B	SWN10-2B	8-36	0.344	0.025	0.094	0.5	1.25
SW10-3B	SWN10-3B	10-32	0.513	0.025	0.094	1.5	3.0
SW10-3BL	SWN10-3BL	10-32	0.513	0.025	0.094	0.5	1.5
SW10-3BH	SWN10-3BH	10-32	0.513	0.025	0.094	2.0	5.0
SW10-4B	SWN10-4B	1/4-20	0.531	0.035	0.125	3.0	7.0
SW10-4BL	SWN10-4BL	1/4-20	0.531	0.035	0.125	2.0	4.0
SW10-4BH	SWN10-4BH	1/4-20	0.531	0.035	0.125	4.0	12.0
SW10-5B	SWN10-5B	5/16-18	0.578	0.040	0.156	4.0	9.0
SW10-5BL	SWN10-5BL	5/16-18	0.578	0.040	0.156	2.0	4.5
SW10-5BH	SWN10-5BH	5/16-18	0.578	0.040	0.156	6.0	17.0
SW10-6B	SWN10-6B	3/8-16	0.625	0.048	0.188	5.0	10.0
SW10-6BL	SWN10-6BL	3/8-16	0.625	0.048	0.188	2.5	5.0
SW10-6BH	SWN10-6BH	3/8-16	0.625	0.048	0.188	6.0	21.0
SW10-8B	SWN10-8B	1/2-13	0.750	0.072	0.281	6.0	12.0
SW10-8BL	SWN10-8BL	1/2-13	0.750	0.072	0.281	3.0	6.0
SW10-8BH	SWN10-8BH	1/2-13	0.750	0.072	0.281	6.0	30.0
SW10-10B	SWN10-10B	5/8-11	0.984	0.096	0.375	9.0	18.0
SW10-10BL	SWN10-10BL	5/8-11	0.984	0.096	0.375	4.5	9.0
SW10-10BH	SWN10-10BH	5/8-11	0.984	0.096	0.375	7.0	50.0

Add "P" to end of part number for optional nylon patch. Do not use the nylon patch if threading into soft material such as aluminum. Add "PT" for nylon pellet.

Ball Plunger

303 Stainless

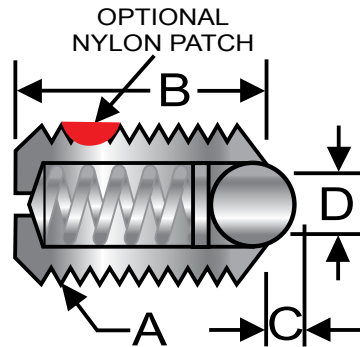

303 Stainless, Inch

Stainless Nose P/N	Nylon Nose P/N	Thread (A)	Body Length (B)	Exposed Length (C)	Ball Dia. (D)	End Force (lbs)	
						Start	Final
SSW10-11B	SSWN10-11B	4-48	0.187	0.020	0.062	0.125	0.5
SSW10-12B	SSWN10-12B	5-40	0.250	0.020	0.062	0.25	0.75
SSW10-1B	SSWN10-1B	6-40	0.312	0.023	0.078	0.5	1.0
SSW10-22B	SSWN10-22B	8-32	0.344	0.025	0.094	0.5	1.25
SSW10-2B	SSWN10-2B	8-36	0.344	0.025	0.094	0.5	1.25
SSW10-3B	SSWN10-3B	10-32	0.513	0.025	0.094	1.5	3.0
SSW10-3BL	SSWN10-3BL	10-32	0.513	0.025	0.094	0.5	1.5
SSW10-3BH	SSWN10-3BH	10-32	0.513	0.025	0.094	2.0	5.0
SSW10-4B	SSWN10-4B	1/4-20	0.531	0.035	0.125	3.0	7.0
SSW10-4BL	SSWN10-4BL	1/4-20	0.531	0.035	0.125	2.0	4.0
SSW10-4BH	SSWN10-4BH	1/4-20	0.531	0.035	0.125	4.0	12.0
SSW10-5B	SSWN10-5B	5/16-18	0.578	0.040	0.156	4.0	9.0
SSW10-5BL	SSWN10-5BL	5/16-18	0.578	0.040	0.156	2.0	4.5
SSW10-5BH	SSWN10-5BH	5/16-18	0.578	0.040	0.156	6.0	17.0
SSW10-6B	SSWN10-6B	3/8-16	0.625	0.048	0.188	5.0	10.0
SSW10-6BL	SSWN10-6BL	3/8-16	0.625	0.048	0.188	2.5	5.0
SSW10-6BH	SSWN10-6BH	3/8-16	0.625	0.048	0.188	6.0	21.0
SSW10-8B	SSWN10-8B	1/2-13	0.750	0.072	0.281	6.0	12.0
SSW10-8BL	SSWN10-8BL	1/2-13	0.750	0.072	0.281	3.0	6.0
SSW10-8BH	SSWN10-8BH	1/2-13	0.750	0.072	0.281	6.0	30.0
SSW10-10B	SSWN10-10B	5/8-11	0.984	0.096	0.375	9.0	18.0
SSW10-10BL	SSWN10-10BL	5/8-11	0.984	0.096	0.375	4.5	9.0
SSW10-10BH	SSWN10-10BH	5/8-11	0.984	0.096	0.375	7.0	50.0

Add "P" to end of part number for optional nylon patch. Do not use the nylon patch if threading into soft material such as aluminum. Add "PT" for nylon pellet.

Ball Plunger

Brass & 316 Stainless

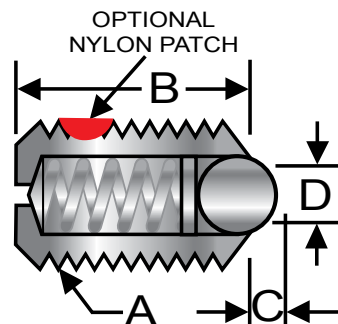

Brass & 316 Stainless, Inch

Brass P/N	316 Stainless P/N	Thread (A)	Body Length (B)	Exposed Length (C)	Ball Dia. (D)	End Force (lbs)	
						Start	Final
SWB10-11B	SSW10-11B-316	4-48	0.187	0.020	0.062	0.125	0.5
SWB10-12B	SSW10-12B-316	5-40	0.250	0.020	0.062	0.25	0.75
SWB10-1B	SSW10-1B-316	6-40	0.312	0.023	0.078	0.5	1.0
SWB10-22B	SSW10-22B-316	8-32	0.344	0.025	0.094	0.5	1.25
SWB10-2B	SSW10-2B-316	8-36	0.344	0.025	0.094	0.5	1.25
SWB10-3B	SSW10-3B-316	10-32	0.513	0.025	0.094	1.5	3.0
SWB10-3BL	SSW10-3BL-316	10-32	0.513	0.025	0.094	0.5	1.5
SWB10-3BH	SSW10-3BH-316	10-32	0.513	0.025	0.094	2.0	5.0
SWB10-4B	SSW10-4B-316	1/4-20	0.531	0.035	0.125	3.0	7.0
SWB10-4BL	SSW10-4BL-316	1/4-20	0.531	0.035	0.125	2.0	4.0
SWB10-4BH	SSW10-4BH-316	1/4-20	0.531	0.035	0.125	4.0	12.0
SWB10-5B	SSW10-5B-316	5/16-18	0.578	0.040	0.156	4.0	9.0
SWB10-5BL	SSW10-5BL-316	5/16-18	0.578	0.040	0.156	2.0	4.5
SWB10-5BH	SSW10-5BH-316	5/16-18	0.578	0.040	0.156	6.0	17.0
SWB10-6B	SSW10-6B-316	3/8-16	0.625	0.048	0.188	5.0	10.0
SWB10-6BL	SSW10-6BL-316	3/8-16	0.625	0.048	0.188	2.5	5.0
SWB10-6BH	SSW10-6BH-316	3/8-16	0.625	0.048	0.188	6.0	21.0
SWB10-8B	SSW10-8B-316	1/2-13	0.750	0.072	0.281	6.0	12.0
SWB10-8BL	SSW10-8BL-316	1/2-13	0.750	0.072	0.281	3.0	6.0
SWB10-8BH	SSW10-8BH-316	1/2-13	0.750	0.072	0.281	6.0	30.0
SWB10-10B	SSW10-10B-316	5/8-11	0.984	0.096	0.375	9.0	18.0
SWB10-10BL	SSW10-10BL-316	5/8-11	0.984	0.096	0.375	4.5	9.0
SWB10-10BH	SSW10-10BH-316	5/8-11	0.984	0.096	0.375	7.0	50.0

Add "P" to end of part number for optional nylon patch. Do not use the nylon patch if threading into soft material such as aluminum. Add "PT" for nylon pellet.



1-800-453-1692

www.aboveboardelectronics.com

Press Fit Ball Nose Plungers

Standard End Force

Steel & Stainless Steel

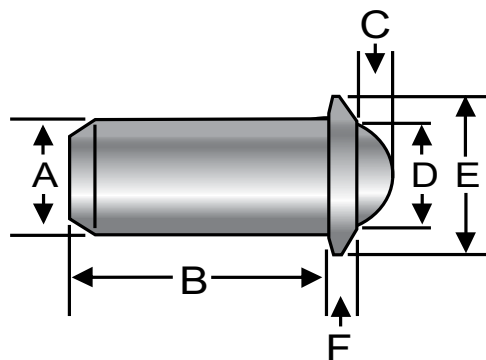

Standard End Force

Steel Body W/ Stainless Ball P/N	Stainless Body W/ Stainless Ball P/N	OD (A)	Body Length (B)	Exposed Length (C)	Nose Dia (D)	Flange Dia (E)	Flange Length (F)	End Force (lbs)	
								Start	Final
SWPF10-2B	SSWPF10-2B	0.125	0.252	0.035	0.094	0.187	0.032	0.75	2.5
SWPF10-3B	SSWPF10-3B	0.188	0.394	0.058	0.156	0.250	0.040	2	5
SWPF10-4B	SSWPF10-4B	0.250	0.471	0.070	0.187	0.312	0.045	3	7
SWPF10-5B	SSWPF10-5B	0.312	0.643	0.090	0.250	0.375	0.045	4	10
SWPF10-6B	SSWPF10-6B	0.375	0.786	0.110	0.312	0.500	0.078	5	14
SWPF10-8B	SSWPF10-8B	0.500	1.100	0.161	0.437	0.688	0.110	8	18

Standard End Force, w/Nylon Ball

Steel Body W/Nylon Ball P/N	Stainless Body W/Nylon Ball P/N	OD (A)	Body Length (B)	Exposed Length (C)	Nose Dia (D)	Flange Dia (E)	Flange Length (F)	End Force (lbs)	
								Start	Final
SWPFN10-2B	SSWPFN10-2B	0.125	0.252	0.035	0.094	0.187	0.032	0.75	2.5
SWPFN10-3B	SSWPFN10-3B	0.188	0.394	0.058	0.156	0.250	0.040	2	5
SWPFN10-4B	SSWPFN10-4B	0.250	0.471	0.070	0.187	0.312	0.045	3	7
SWPFN10-5B	SSWPFN10-5B	0.312	0.643	0.090	0.250	0.375	0.045	4	10
SWPFN10-6B	SSWPFN10-6B	0.375	0.786	0.110	0.312	0.500	0.078	5	14
SWPFN10-8B	SSWPFN10-8B	0.500	1.100	0.161	0.437	0.688	0.110	8	18

Press Fit Ball Nose Plungers

Light End Force

Steel & Stainless Steel

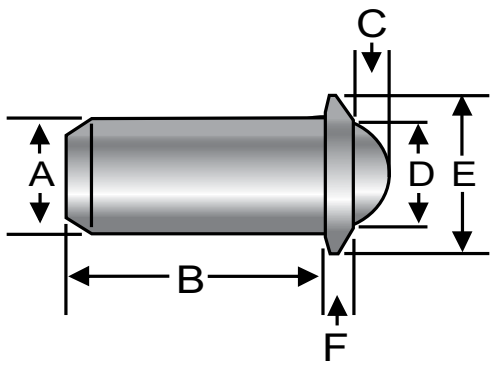

Light End Force

Steel Body W/ Stainless Ball P/N	Stainless Body W/ Stainless Ball P/N	OD (A)	Body Length (B)	Exposed Length (C)	Nose Dia (D)	Flange Dia (E)	Flange Length (F)	End Force (lbs)	
								Start	Final
SWPF10-2BL	SSWPF10-2BL	0.125	0.252	0.035	0.094	0.187	0.032	0.4	1.3
SWPF10-3BL	SSWPF10-3BL	0.188	0.394	0.058	0.156	0.250	0.040	1	2.5
SWPF10-4BL	SSWPF10-4BL	0.250	0.471	0.070	0.187	0.312	0.045	1.5	3.5
SWPF10-5BL	SSWPF10-5BL	0.312	0.643	0.090	0.250	0.375	0.045	2	5
SWPF10-6BL	SSWPF10-6BL	0.375	0.786	0.110	0.312	0.500	0.078	2.5	7
SWPF10-8BLL	SSWPF10-8BL	0.500	1.100	0.161	0.437	0.688	0.110	4	9

Light End Force, w/Nylon Ball

Steel Body W/Nylon Ball P/N	Stainless Body W/Nylon Ball P/N	OD (A)	Body Length (B)	Exposed Length (C)	Nose Dia (D)	Flange Dia (E)	Flange Length (F)	End Force (lbs)	
								Start	Final
SWPFN10-2BL	SSWPFN10-2BL	0.125	0.252	0.035	0.094	0.187	0.032	0.4	1.3
SWPFN10-3BL	SSWPFN10-3BL	0.188	0.394	0.058	0.156	0.250	0.040	1	2.5
SWPFN10-4BL	SSWPFN10-4BL	0.250	0.471	0.070	0.187	0.312	0.045	1.5	3.5
SWPFN10-5BL	SSWPFN10-5BL	0.312	0.643	0.090	0.250	0.375	0.045	2	5
SWPFN10-6BL	SSWPFN10-6BL	0.375	0.786	0.110	0.312	0.500	0.078	2.5	7
SWPFN10-8BL	SSWPFN10-8BL	0.500	1.100	0.161	0.437	0.688	0.110	4	9

Press Fit Round Nose Plungers

Steel & Stainless Steel

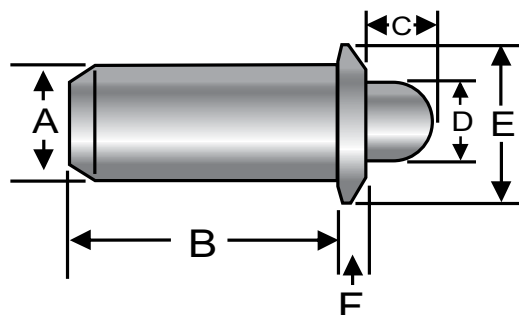

Steel-Standard End Force

Steel P/N	Stainless P/N	OD (A)	Body Length (B)	Exposed Length (C)	Nose Dia (D)	Flange Dia (E)	Flange Length (F)	End Force (lbs)	
								Start	Final
SWPF10-3	SSWPF10-3	0.188	0.441	0.094	0.121	0.250	0.044	1.5	4.5
SWPF10-4	SSWPF10-4	0.250	0.521	0.125	0.168	0.312	0.055	2.5	6
SWPF10-6	SSWPF10-6	0.375	0.786	0.187	0.234	0.500	0.096	5	14
SWPF10-8	SSWPF10-8	0.500	1.100	0.250	0.332	0.688	0.134	8	18

Steel-Light End Force

Steel P/N	Stainless P/N	OD (A)	Body Length (B)	Exposed Length (C)	Nose Dia (D)	Flange Dia (E)	Flange Length (F)	End Force (lbs)	
								Start	Final
SWPF10-3A	SSWPF10-3A	0.188	0.441	0.094	0.121	0.250	0.044	0.75	2
SWPF10-4A	SSWPF10-4A	0.250	0.521	0.125	0.168	0.312	0.055	1.25	3
SWPF10-6A	SSWPF10-6A	0.375	0.786	0.187	0.234	0.500	0.096	2.5	7
SWPF10-8A	SSWPF10-8A	0.500	1.100	0.250	0.332	0.688	0.134	4	9