

PolyMount™ Leveling Mounts

Patent# US 6,742,750 B2

PolyMounts™ are economical leveling mounts for light, medium, and heavy-duty applications. The sleek design is suitable for everything from production machinery, conveyors and electronic equipment to retail displays and expensive office furniture.

The one-piece ball with stud swivels 15° in all directions and is forged and roll-threaded for maximum strength and durability. Standard stud materials are clear zinc plated steel and stainless steel. For applications where a stud is already in place, a one-piece tapped ball version is available.



The molded base is corrosion resistant glass-reinforced nylon and has pop-out lag holes for securing the mounts to the floor. Diameters range from 1.5" to 5" and capacities are as high as 10,000 pounds. For anti-skid applications and light-duty vibration control, PolyMounts™ are available with an elastomer pad.

For especially harsh applications our exclusive SocketLock™ technology will lock the stud in place, preventing pullout.

Specifications:

- Glass-reinforced nylon base
- Studs are either low carbon steel with clear zinc plating or 303 stainless steel
- One-piece forged and roll-threaded stud or
- One-piece tapped ball
- Pop-out lag holes
- Inch and metric sizes
- Mounts with studs furnished with jam nut
- Patent Pending

Standard Options:

- Non-skid elastomer pad
- SocketLock™



Request Info





1-800-453-1692

www.aboveboardelectronics.com

PolyMounts™

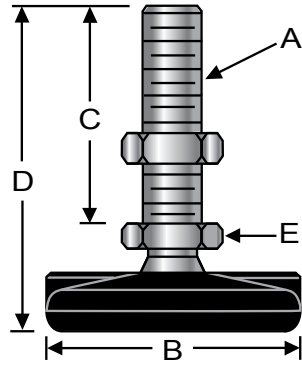
Stud Style 1.58", 2", 3", 4" Dia. Base, Inch



Patent# US 6,742,750 B2

Steel P/N	303 Stainless P/N	Thread (A)	Base Dia (B)	Thread Length (C)	Total Height (D)	Hex Size (E)	Max Load (lbs)	Ship Wt. (lbs)
BNYLA13	BSNYLA13	3/8-16	1.58	3	4 1/16	3/4	2500	0.20
BNYLA23	BSNYLA23	3/8-16	2	3	4 1/8	3/4	4000	0.20
BNYLA24	BSNYLA24	3/8-16	2	4	5 1/8	3/4	4000	0.24
BNYLA26	BSNYLA26	3/8-16	2	6	7 1/8	3/4	4000	0.26
BNYLA28	BSNYLA28	3/8-16	2	8	9 1/8	3/4	4000	0.32
BNYLB23	BSNYLB23	1/2-13	2	3	4 1/8	3/4	4000	0.26
BNYLB24	BSNYLB24	1/2-13	2	4	5 1/8	3/4	4000	0.34
BNYLB26	BSNYLB26	1/2-13	2	6	7 1/8	3/4	4000	0.42
BNYLB28	BSNYLB28	1/2-13	2	8	9 1/8	3/4	4000	0.52
BNYLC23	BSNYLC23	5/8-11	2	3	4 1/8	7/8	4000	0.28
BNYLC24	BSNYLC24	5/8-11	2	4	5 1/8	7/8	4000	0.30
BNYLC26	BSNYLC26	5/8-11	2	6	7 1/8	7/8	4000	0.54
BNYLC28	BSNYLC28	5/8-11	2	8	9 1/8	7/8	4000	0.76
BNYLA34	BSNYLA34	3/8-16	3	4	5 1/8	3/4	5000	0.28
BNYLA36	BSNYLA36	3/8-16	3	6	7 1/8	3/4	5000	0.32
BNYLA38	BSNYLA38	3/8-16	3	8	9 1/8	3/4	5000	0.40
BNYLB34	BSNYLB34	1/2-13	3	4	5 1/8	3/4	5000	0.42
BNYLB36	BSNYLB36	1/2-13	3	6	7 1/8	3/4	5000	0.50
BNYLB38	BSNYLB38	1/2-13	3	8	9 1/8	3/4	5000	0.60
BNYLC34	BSNYLC34	5/8-11	3	4	5 1/8	7/8	5000	0.58
BNYLC36	BSNYLC36	5/8-11	3	6	7 1/8	7/8	5000	0.72
BNYLC38	BSNYLC38	5/8-11	3	8	9 1/8	7/8	5000	0.86
BNYLD34	BSNYLD34	3/4-10	3	4	5 1/8	1 1/16	5000	0.74
BNYLD36	BSNYLD36	3/4-10	3	6	7 1/8	1 1/16	5000	0.88
BNYLD38	BSNYLD38	3/4-10	3	8	9 1/8	1 1/16	5000	1.16
BNYLA44	BSNYLA44	3/8-16	4	4	5 5/16	3/4	3500	0.44
BNYLA46	BSNYLA46	3/8-16	4	6	7 5/16	3/4	3500	0.46
BNYLA48	BSNYLA48	3/8-16	4	8	9 5/16	3/4	3500	0.50
BNYLB44	BSNYLB44	1/2-13	4	4	5 5/16	3/4	5000	0.54
BNYLB46	BSNYLB46	1/2-13	4	6	7 5/16	3/4	5000	0.62
BNYLB48	BSNYLB48	1/2-13	4	8	9 5/16	3/4	5000	0.76
BNYLC44	BSNYLC44	5/8-11	4	4	5 5/16	7/8	6000	0.70
BNYLC46	BSNYLC46	5/8-11	4	6	7 5/16	7/8	6000	0.84
BNYLC48	BSNYLC48	5/8-11	4	8	9 5/16	7/8	6000	1.00
BNYLD44	BSNYLD44	3/4-10	4	4	5 5/16	1 1/16	7500	0.84
BNYLD46	BSNYLD46	3/4-10	4	6	7 5/16	1 1/16	7500	0.98
BNYLD48	BSNYLD48	3/4-10	4	8	9 5/16	1 1/16	7500	1.28
BNYLE44	BSNYLE44	1-8	4	4	5 5/16	1 3/8	7500	1.20
BNYLE46	BSNYLE46	1-8	4	6	7 5/16	1 3/8	7500	1.58
BNYLE48	BSNYLE48	1-8	4	8	9 5/16	1 3/8	7500	1.96

For non-skid elastomer pad, add -EL to the end of the part number. Add 1/16" to the overall height. For SocketLock™, add -SL to end of part number.

 Request Info 1-800-453-1692
www.aboveboardelectronics.com

PolyMounts™

Stud Style 1.58", 2", 3", 4" Dia. Base, Metric

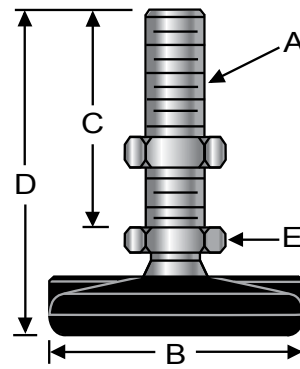

Patent# US 6,742,750 B2

Steel P/N	303 Stainless P/N	Thread (A)	Base Dia (B)	Thread Length (C)	Total Height (D)	Hex Size (E)	Max Load (kg)	Ship Wt. (lbs)
BMNYLA13	BSMNYLA13	M10	40	76	104	20	1135	0.20
BMNYLA23	BSMNYLA23	M10	51	76	105	20	1818	0.20
BMNYLA24	BSMNYLA24	M10	51	102	130	20	1818	0.24
BMNYLA26	BSMNYLA26	M10	51	152	181	20	1818	0.26
BMNYLA28	BSMNYLA28	M10	51	203	232	20	1818	0.32
BMNYLB23	BSMNYLB23	M12	51	76	105	20	1818	0.26
BMNYLB24	BSMNYLB24	M12	51	102	130	20	1818	0.34
BMNYLB26	BSMNYLB26	M12	51	152	181	20	1818	0.42
BMNYLB28	BSMNYLB28	M12	51	203	232	20	1818	0.52
BMNYLC23	BSMNYLC23	M16	51	76	105	22	1818	0.28
BMNYLC24	BSMNYLC24	M16	51	102	130	22	1818	0.30
BMNYLC26	BSMNYLC26	M16	51	152	181	22	1818	0.54
BMNYLC28	BSMNYLC28	M16	51	203	232	22	1818	0.76
BMNYLA34	BSMNYLA34	M10	76	102	130	20	2270	0.28
BMNYLA36	BSMNYLA36	M10	76	152	181	20	2270	0.32
BMNYLA38	BSMNYLA38	M10	76	203	232	20	2270	0.40
BMNYLB34	BSMNYLB34	M12	76	102	130	20	2270	0.42
BMNYLB36	BSMNYLB36	M12	76	152	181	20	2270	0.50
BMNYLB38	BSMNYLB38	M12	76	203	232	20	2270	0.60
BMNYLC34	BSMNYLC34	M16	76	102	130	22	2270	0.58
BMNYLC36	BSMNYLC36	M16	76	152	181	22	2270	0.72
BMNYLC38	BSMNYLC38	M16	76	203	232	22	2270	0.86
BMNYLD34	BSMNYLD34	M20	76	102	130	27	2270	0.74
BMNYLD36	BSMNYLD36	M20	76	152	181	27	2270	0.88
BMNYLD38	BSMNYLD38	M20	76	203	232	27	2270	1.16
BMNYLA44	BSMNYLA44	M10	102	102	135	20	1590	0.44
BMNYLA46	BSMNYLA46	M10	102	152	185	20	1590	0.46
BMNYLA48	BSMNYLA48	M10	102	203	236	20	1590	0.50
BMNYLB44	BSMNYLB44	M12	102	102	135	20	2270	0.54
BMNYLB46	BSMNYLB46	M12	102	152	185	20	2270	0.62
BMNYLB48	BSMNYLB48	M12	102	203	236	20	2270	0.76
BMNYLC44	BSMNYLC44	M16	102	102	135	22	2725	0.70
BMNYLC46	BSMNYLC46	M16	102	152	185	22	2725	0.84
BMNYLC48	BSMNYLC48	M16	102	203	236	22	2725	1.00
BMNYLD44	BSMNYLD44	M20	102	102	135	27	3409	0.84
BMNYLD46	BSMNYLD46	M20	102	152	185	27	3409	0.98
BMNYLD48	BSMNYLD48	M20	102	203	236	27	3409	1.28
BMNYLE44	BSMNYLE44	M24	102	102	135	35	3409	1.20
BMNYLE46	BSMNYLE46	M24	102	152	185	35	3409	1.58
BMNYLE48	BSMNYLE48	M24	102	203	236	35	3409	1.96

For non-skid elastomer pad, add **-EL** to the end of the part number. Add **1.6mm** to the overall height. For SocketLock™, add **-SL** to end of part number.

PolyMounts™

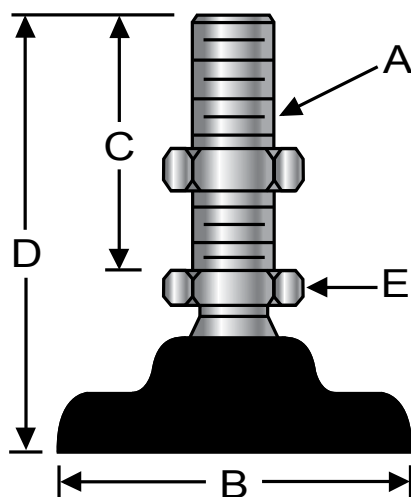

Patent# US 6,742,750 B2

Stud Style 5" Dia. Base, Inch

Steel P/N	303 Stainless P/N	Thread (A)	Base Dia (B)	Thread Length (C)	Total Height (D)	Hex Size (E)	Max Load (lbs)	Ship Wt. (lbs)
BNYLC54	BSNYLC54	5/8-11	5	4	6 1/4	1 1/16	10000	1.12
BNYLC56	BSNYLC56	5/8-11	5	6	8 1/4	1 1/16	10000	1.26
BNYLC58	BSNYLC58	5/8-11	5	8	10 1/4	1 1/16	10000	1.40
BNYLC510	BSNYLC510	5/8-11	5	10	12 1/4	1 1/16	10000	1.63
BNYLD54	BSNYLD54	3/4-10	5	4	6 1/4	1 1/16	10000	1.22
BNYLD56	BSNYLD56	3/4-10	5	6	8 1/4	1 1/16	10000	1.39
BNYLD58	BSNYLD58	3/4-10	5	8	10 1/4	1 1/16	10000	1.56
BNYLD510	BSNYLD510	3/4-10	5	10	12 1/4	1 1/16	10000	1.70
BNYLE54	BSNYLE54	1-8	5	4	6 1/4	1 3/8	10000	1.66
BNYLE56	BSNYLE56	1-8	5	6	8 1/4	1 3/8	10000	1.83
BNYLE58	BSNYLE58	1-8	5	8	10 1/4	1 3/8	10000	2.00
BNYLE510	BSNYLE510	1-8	5	10	12 1/4	1 3/8	10000	2.17
BNYLF54	BSNYLF54	1 1/8-7	5	4	6 1/4	1 3/8	10000	2.20
BNYLF56	BSNYLF56	1 1/8-7	5	6	8 1/4	1 3/8	10000	2.37
BNYLF58	BSNYLF58	1 1/8-7	5	8	10 1/4	1 3/8	10000	2.54
BNYLF510	BSNYLF510	1 1/8-7	5	10	12 1/4	1 3/8	10000	1.71
BNYLG54	BSNYLG54	1 1/4-7	5	4	6 1/4	1 7/8	10000	2.84
BNYLG56	BSNYLG56	1 1/4-7	5	6	8 1/4	1 7/8	10000	3.01
BNYLG58	BSNYLG58	1 1/4-7	5	8	10 1/4	1 7/8	10000	3.18
BNYLG510	BSNYLG510	1 1/4-7	5	10	12 1/4	1 7/8	10000	3.35

For SocketLock™, add -SL to the end of the part number.

Non-Skid Pad for 5" PolyMounts™

P/N	Base Dia	Total Height	Max Load (lbs)	Ship Wt. (lbs)
PMR-WH-5	5	.31	10000	0.3



Request Info

1-800-453-1692

www.aboveboardelectronics.com

PolyMounts™

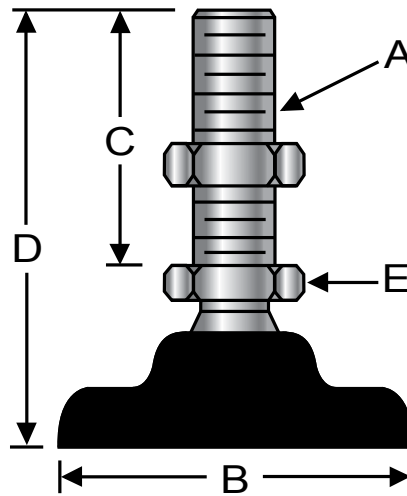

Patent# US 6,742,750 B2

Stud Style, 5" Dia. Base, Metric

Steel P/N	303 Stainless P/N	Thread (A)	Base Dia (B)	Thread Length (C)	Total Height (D)	Hex Size (E)	Max Load (kg)	Ship Wt. (lbs)
BMNYLC54	BSMNYLC54	M16	127	102	159	27	4545	1.12
BMNYLC56	BSMNYLC56	M16	127	152	210	27	4545	1.26
BMNYLC58	BSMNYLC58	M16	127	203	260	27	4545	1.40
BMNYLC510	BSMNYLC510	M16	127	254	311	27	4545	1.63
BMNYLD54	BSMNYLD54	M20	127	102	159	27	4545	1.22
BMNYLD56	BSMNYLD56	M20	127	152	210	27	4545	1.39
BMNYLD58	BSMNYLD58	M20	127	203	260	27	4545	1.56
BMNYLD510	BSMNYLD510	M20	127	254	311	27	4545	1.70
BMNYLE54	BSMNYLE54	M24	127	102	159	35	4545	1.66
BMNYLE56	BSMNYLE56	M24	127	152	210	35	4545	1.83
BMNYLE58	BSMNYLE58	M24	127	203	260	35	4545	2.00
BMNYLE510	BSMNYLE510	M24	127	254	311	35	4545	2.17
BMNYLF54	BSMNYLF54	M30	127	102	159	35	4545	2.20
BMNYLF56	BSMNYLF56	M30	127	152	210	35	4545	2.37
BMNYLF58	BSMNYLF58	M30	127	203	260	35	4545	2.54
BMNYLF510	BSMNYLF510	M30	127	254	311	35	4545	1.71

For SocketLock™, add -SL to the end of the part number.

Non-Skid Pad for 5" PolyMounts™

P/N	Base Dia	Total Height	Max Load (lbs)	Ship Wt. (lbs)
PMR-WH-5	5	.31	10000	0.3



Request Info



1-800-453-1692

www.aboveboardelectronics.com

PolyMounts™

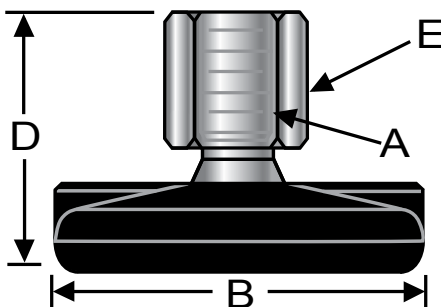

Patent# US 6,742,750 B2

Tapped Style 1.58", 2", 3", 4" Dia. Base, Inch

Steel P/N	303 Stainless P/N	Thread (A)	Base Dia (B)	Total Height (D)	Hex Size (E)	Max Load (lbs)	Ship Wt. (lbs)
BNYLA1-T	BSNYLA1-T	3/8-16	1.58	1 3/8	5/8	2500	0.14
BNYLA2-T	BSNYLA2-T	3/8-16	2	1 7/16	5/8	4000	0.14
BNYLB2-T	BSNYLB2-T	1/2-13	2	1 5/8	3/4	4000	0.16
BNYLC2-T	BSNYLC2-T	5/8-11	2	1 11/16	7/8	4000	0.18
BNYLA3-T	BSNYLA3-T	3/8-16	3	1 7/16	5/8	5000	0.22
BNYLB3-T	BSNYLB3-T	1/2-13	3	1 5/8	3/4	5000	0.24
BNYLC3-T	BSNYLC3-T	5/8-11	3	1 11/16	7/8	5000	0.26
BNYLD3-T	BSNYLD3-T	3/4-10	3	1 13/16	1 1/16	5000	0.34
BNYLA4-T	BSNYLA4-T	3/8-16	4	1 5/8	5/8	3500	0.36
BNYLB4-T	BSNYLB4-T	1/2-13	4	1 13/16	3/4	5000	0.40
BNYLC4-T	BSNYLC4-T	5/8-11	4	1 7/8	7/8	6000	0.42
BNYLD4-T	BSNYLD4-T	3/4-10	4	2	1 1/16	7500	0.50
BNYLE4-T	BSNYLE4-T	1-8	4	2 3/8	1 3/8	7500	0.94

For non-skid elastomer pad, add **-EL** to the end of the part number. Add **1/16" (1.6mm)** to the overall height.
For SocketLock™, add **-SL** to end of part number.

Tapped Style 1.58", 2", 3", 4" Dia. Base, Metric

Steel P/N	303 Stainless P/N	Thread (A)	Base Dia (B)	Total Height (D)	Hex Size (E)	Max Load (kg)	Ship Wt. (lbs)
BMNYLA1-T	BSMNYLA1-T	M10	40	35	16	1135	0.14
BMNYLA2-T	BSMNYLA2-T	M10	51	37	16	1818	0.14
BMNYLB2-T	BSMNYLB2-T	M12	51	41	20	1818	0.16
BMNYLC2-T	BSMNYLC2-T	M16	51	43	22	1818	0.18
BMNYLA3-T	BSMNYLA3-T	M10	76	37	16	2270	0.22
BMNYLB3-T	BSMNYLB3-T	M12	76	41	20	2270	0.24
BMNYLC3-T	BSMNYLC3-T	M16	76	43	22	2270	0.26
BMNYLD3-T	BSMNYLD3-T	M20	76	46	27	2270	0.34
BMNYLA4-T	BSMNYLA4-T	M10	102	41	16	1590	0.36
BMNYLB4-T	BSMNYLB4-T	M12	102	46	20	2270	0.40
BMNYLC4-T	BSMNYLC4-T	M16	102	48	22	2725	0.42
BMNYLD4-T	BSMNYLD4-T	M20	102	51	27	3409	0.50
BMNYLE4-T	BSMNYLE4-T	M24	102	60	35	3409	0.94

For non-skid elastomer pad, add **-EL** to the end of the part number. Add **1/16" (1.6mm)** to the overall height.
For SocketLock™, add **-SL** to end of part number.



Request Info 1-800-453-1692
www.aboveboardelectronics.com

PolyMounts™

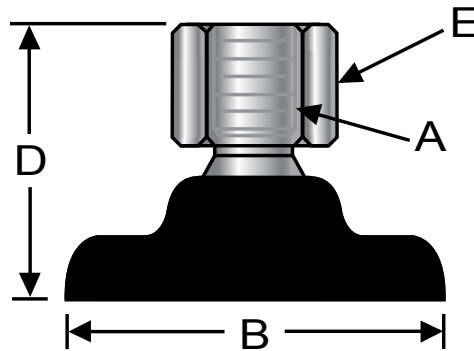

Patent# US 6,742,750 B2

Tapped Style 5" Dia. Base, Inch

Steel P/N	303 Stainless P/N	Thread (A)	Base Dia (B)	Total Height (D)	Hex Size (E)	Max Load (lbs)	Ship Wt. (lbs)
BNYLC5-T	BSNYLC5-T	5/8-11	5	3	1 1/16	10000	1.12
BNYLD5-T	BSNYLD5-T	3/4-10	5	3	1 1/16	10000	1.12
BNYLE5-T	BSNYLE5-T	1-8	5	3	1 3/8	10000	1.12
BNYLF5-T	BSNYLF5-T	1 1/8-7	5	3	1 3/8	10000	1.12

For SocketLock™, add **-SL** to the end of the part number.

Tapped Style 5" Dia. Base, Metric

Steel P/N	303 Stainless P/N	Thread (A)	Base Dia (B)	Total Height (D)	Hex Size (E)	Max Load (kg)	Ship Wt. (lbs)
BMNYLC5-T	BSMNYLC5-T	M16	127	76	27	4545	1.12
BMNYLD5-T	BSMNYLD5-T	M20	127	76	27	4545	1.12
BMNYLE5-T	BSMNYLE5-T	M24	127	76	35	4545	1.12
BMNYLF5-T	BSMNYLF5-T	M30	127	76	35	4545	1.12

For SocketLock™, add **-SL** to the end of the part number.

Non-Skid Pad for 5" PolyMounts™

P/N	Base Dia	Total Height	Max Load (lbs)	Ship Wt. (lbs)
PMR-WH-5	5	.31	10000	0.3



Request Info



1-800-453-1692

www.aboveboardelectronics.com

PolyMounts™

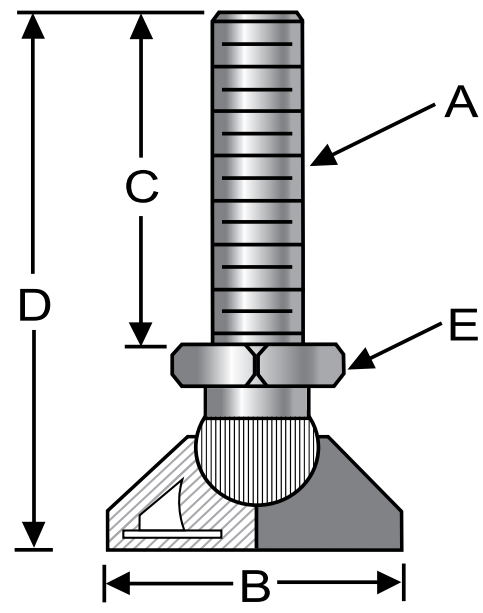

Stud Style 2-3/8" Dia. Base, Inch

Steel P/N	303 Stainless P/N	Ni Plated Brass	Thread (A)	Base Dia (B)	Thread Length (C)	Total Height (D)	Hex Size (E)	Max Load (lbs)	Ship Wt. (lbs)
BNYLB63	BSNYLB63	BRNYLB63	1/2-13	2 3/8	3	4 7/8	1	3000	0.52
BNYLB66	BSNYLB66	BRNYLB66	1/2-13	2 3/8	6	7 7/8	1	3000	0.64
BNYLC63	BSNYLC63	BRNYLC63	5/8-11	2 3/8	3	4 7/8	1	3500	0.68
BNYLC66	BSNYLC66	BRNYLC66	5/8-11	2 3/8	6	7 7/8	1	3500	0.80
BNYLD63	BSNYLD63	BRNYLD63	3/4-10	2 3/8	3	4 7/8	1	3500	0.90
BNYLD66	BSNYLD66	BRNYLD66	3/4-10	2 3/8	6	7 7/8	1	3500	1.01

Stud Style 2-3/8" Dia. Base, Metric

Steel P/N	303 Stainless P/N	Ni Plated Brass	Thread (A)	Base Dia (B)	Thread Length (C)	Total Height (D)	Hex Size (E)	Max Load (kg)	Ship Wt. (lbs)
MBNYLB63	MBSNYLB63	MBRNYLB63	M12	60	76	124	25	1360	0.52
MBNYLB66	MBSNYLB66	MBRNYLB66	M12	60	152	200	25	1360	0.64
MBNYLC63	MBSNYLC63	MBRNYLC63	M16	60	76	124	25	1590	0.68
MBNYLC66	MBSNYLC66	MBRNYLC66	M16	60	152	200	25	1590	0.80
MBNYLD63	MBSNYLD63	MBRNYLD63	M20	60	76	124	25	1590	0.90
MBNYLD66	MBSNYLD66	MBRNYLD66	M20	60	152	200	25	1590	1.01



Request Info
* 🛒 🕒

1-800-453-1692
www.aboveboardelectronics.com