

# 1/8 ROUND INTERNAL THREAD HANDLES

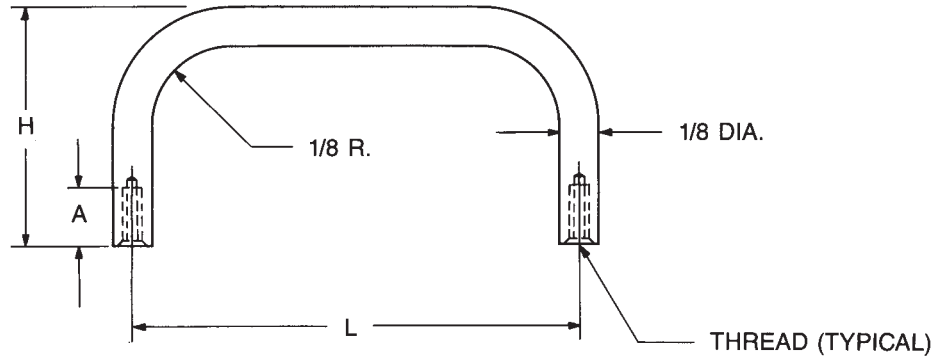

PART NO.	L ± 1/32	H ± 1/32
8000	3/4	1/2
8001	13/16	
8002	7/8	
8003	1"	
8004	1-1/4	
8005	1-1/2	
8006	2"	
8007	3/4	3/4
8008	13/16	
8009	7/8	
8010	1"	
8011	1-1/4	
8012	1-1/2	
8013	2"	
8014	1"	1"
8015	1-1/4	
8016	1-1/2	
8017	1-3/4	
8018	2"	

PART NO.	L ± 1/32	H ± 1/32
8019	1"	1-1/4
8020	1-1/4	
8021	1-1/2	
8022	1-3/4	
8023	2"	
8024	1"	1-1/2
8025	1-1/4	
8026	1-1/2	
8027	1-3/4	
8028	2"	
8029	1-1/4	2"
8030	1-1/2	
8031	1-3/4	
8032	2"	
8033	2-1/2	
8034	3"	

See page 4H for finish codes  
For non-standard parts contact Sales Office

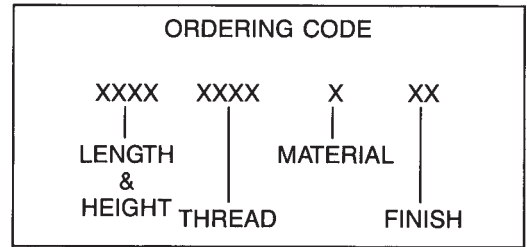

THREAD CODE & DEPTH		
THREAD	CODE	A
2-56	256	3/16

MATERIAL	CODE	RoHS
Aluminum	A	YES
Brass	B	YES
Stainless Steel	SS	YES
Steel	S	YES

# 5/32 ROUND INTERNAL THREAD HANDLES

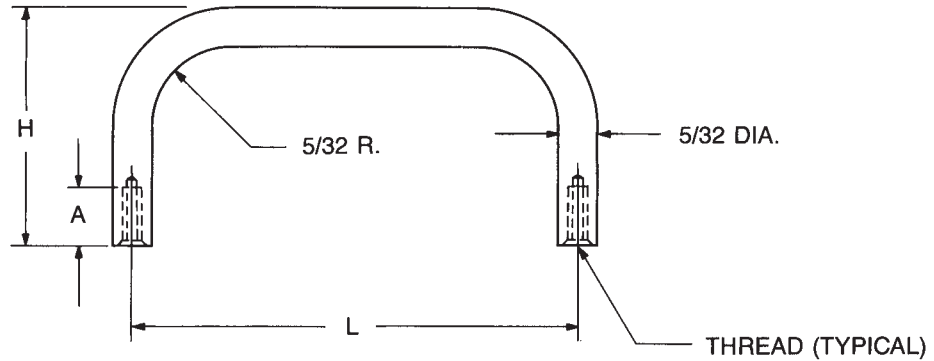

PART NO.	L ± 1/32	H ± 1/32
8035	1"	
8036	1-1/4	
8037	1-1/2	
8038	2"	3/4
8039	2-1/2	
8040	3"	
8041	1"	
8042	1-1/4	
8043	1-1/2	
8044	1-3/4	1"
8045	2"	
8046	2-1/2	
8047	3"	

See page 4H for finish codes  
For non-standard parts contact Sales Office

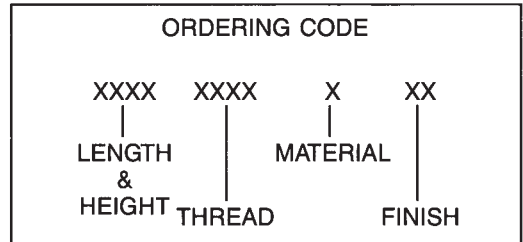

THREAD CODE & DEPTH		
THREAD	CODE	A
2-56	256	3/16
4-40	440	1/4-3/8

MATERIAL	CODE	RoHS
Aluminum	A	YES
Brass	B	YES
Stainless Steel	SS	YES
Steel	S	YES



# 3/16 ROUND INTERNAL THREAD HANDLES

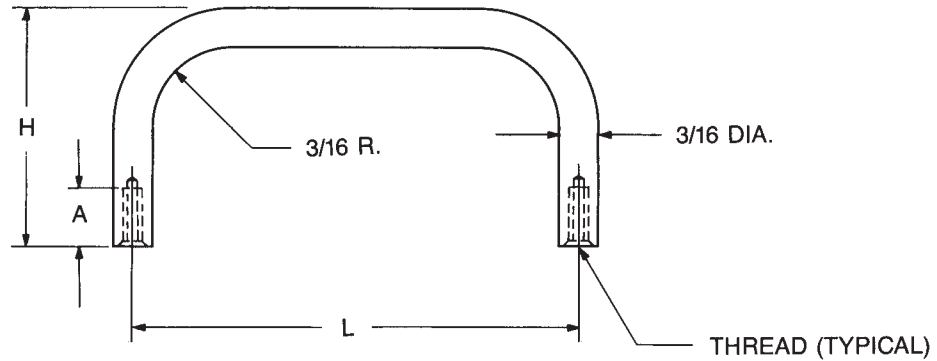

PART NO.	L ± 1/32	H ± 1/32
8048	1-1/2	5/8
8049	1-3/4	
8050	2"	
8051	3"	
8052	4"	
8053	5"	
8054	1"	3/4
8055	1-1/4	
8056	1-1/2	
8057	1-3/4	
8058	2"	
8059	3"	
8060	4"	
8061	5"	
8062	1"	7/8
8063	1-1/4	
8064	1-1/2	
8065	1-3/4	
8066	2"	
8067	3"	
8068	4"	
8069	5"	
8070	1"	1"
8071	1-1/4	
8072	1-1/2	
8073	1-3/4	
8074	2"	
8075	3"	
8076	4"	
8077	5"	

PART NO.	L ± 1/32	H ± 1/32
8078	1"	1-1/8
8079	1-1/4	
8080	1-1/2	
8081	1-3/4	
8082	2"	
8083	3"	
8084	4"	
8085	5"	
8086	1"	1-1/4
8087	1-1/4	
8088	1-1/2	
8089	1-3/4	
8090	2"	
8091	3"	
8092	4"	
8093	5"	
8094	1"	1-1/2
8095	1-1/4	
8096	1-1/2	
8097	1-3/4	
8098	2"	
8099	3"	
8100	4"	
8101	5"	

See page 4H for finish codes  
For non-standard parts contact Sales Office

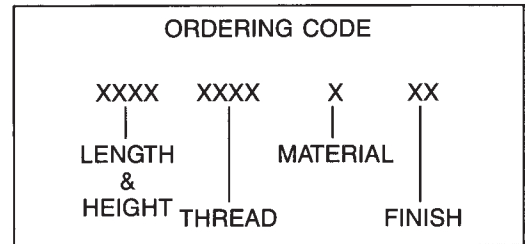

THREAD CODE & DEPTH		
THREAD	CODE	A
4-40	440	1/4
6-32	632	5/16-3/8

MATERIAL	CODE	RoHS
Aluminum	A	YES
Brass	B	YES
Stainless Steel	SS	YES
Steel	S	YES

# 1/4 ROUND INTERNAL THREAD HANDLES

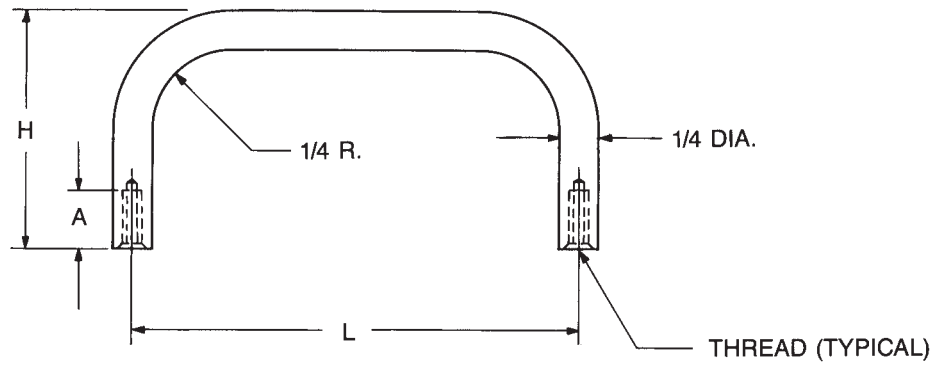

PART NO.	L ± 1/32	H ± 1/32
8102	1-1/8	
8103	1-1/4	
8104	1-1/2	
8105	1-3/4	
8106	2"	
8107	2-1/4	1"
8108	2-1/2	
8109	2-3/4	
8110	3"	
8111	4"	
8112	5"	
8113	1-1/2	
8114	1-3/4	
8115	2"	
8116	2-1/4	
8117	2-1/2	1-1/4
8118	2-3/4	
8119	3"	
8120	4"	
8121	5"	

PART NO.	L ± 1/32	H ± 1/32
8122	1-1/2	
8123	1-3/4	
8124	2"	
8125	2-1/4	
8126	2-1/2	
8127	2-3/4	1-1/2
8128	3"	
8129	3-1/2	
8130	4"	
8131	4-1/4	
8132	4-1/2	
8133	5"	
8134	6"	
8135	3"	
8136	4"	
8137	5"	2"
8138	6"	

See page 4H for finish codes  
For non-standard parts contact Sales Office

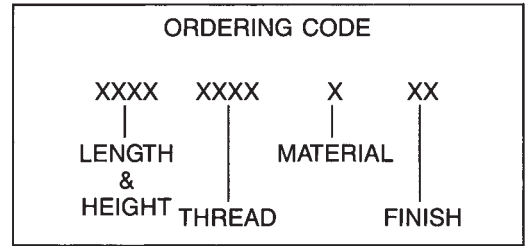

THREAD CODE & DEPTH		
THREAD	CODE	A
6-32	632	3/8
8-32	832	7/16-9/16

MATERIAL	CODE	RoHS
Aluminum	A	YES
Brass	B	YES
Stainless Steel	SS	YES
Steel	S	YES



# 5/16 ROUND INTERNAL THREAD HANDLES

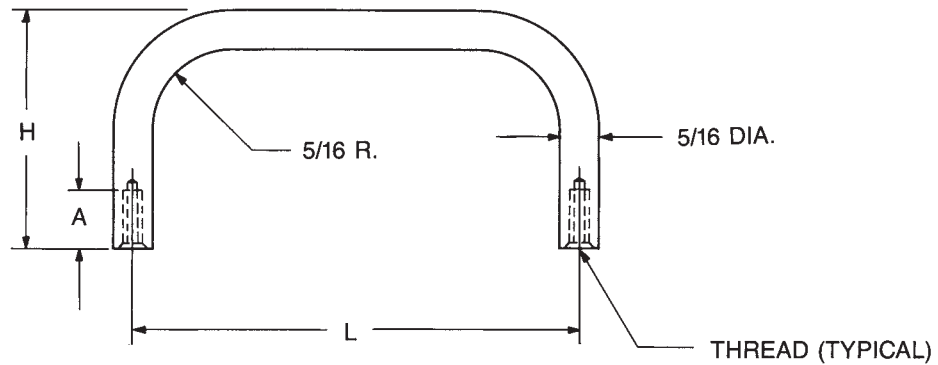

PART NO.	L ± 1/32	H ± 1/32	
8139	2"	1"	
8140	2-1/2		
8141	3"		
8142	3-1/2		
8143	4"		
8144	4-1/4		
8145	4-1/2		
8146	5"		
8147	6"		
8148	2"		1-1/8
8149	3"		
8150	4"		
8151	4-1/4		
8152	4-9/16		
8153	2"	1-1/4	
8154	2-1/2		
8155	3"		
8156	3-1/2		
8157	4"		
8158	2"		1-5/16
8159	2-1/4		
8160	2-1/2		
8161	2-3/4		
8162	2-13/16		
8163	3"		
8164	4"		
8165	4-1/4		
8166	2"	1-3/8	
8167	2-1/2		
8168	3"		
8169	4"		
8170	4-1/4		
8171	5"		

PART NO.	L ± 1/32	H ± 1/32
8172	2"	1-1/2
8173	2-1/8	
8174	2-1/4	
8175	2-3/8	
8176	2-1/2	
8177	2-3/4	
8178	3"	
8179	3-1/8	
8180	3-1/4	
8181	3-1/2	
8182	4"	1-1/2
8183	4-1/4	
8184	4-1/2	
8185	4-9/16	
8186	4-5/8	
8187	5"	
8188	5-1/4	
8189	5-1/2	
8190	5-3/4	
8191	6"	
8192	6-7/16	1-1/2
8193	6-1/2	
8194	7"	

PART NO.	L ± 1/32	H ± 1/32
8195	3"	1-3/4
8196	3-1/2	
8197	4"	
8198	4-1/4	
8199	4-1/2	
8200	4-9/16	
8201	4-5/8	
8202	4-3/4	
8203	5"	
8204	5-1/8	
8205	5-1/4	1-3/4
8206	5-1/2	
8207	5-3/4	
8208	6"	
8209	6-1/4	
8210	6-7/16	
8211	6-1/2	
8212	6-3/4	
8213	7"	

MATERIAL	CODE	RoHS
Aluminum	A	YES
Brass	B	YES
Stainless Steel	SS	YES
Steel	S	YES

See page 4H for finish codes  
For non-standard parts  
contact Sales Office

THREAD CODE & DEPTH		
THREAD	CODE	A
8-32	832	7/16
10-32	1032	5/16-5/8

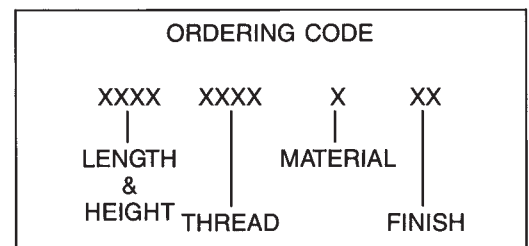

# 3/8 ROUND INTERNAL THREAD HANDLES

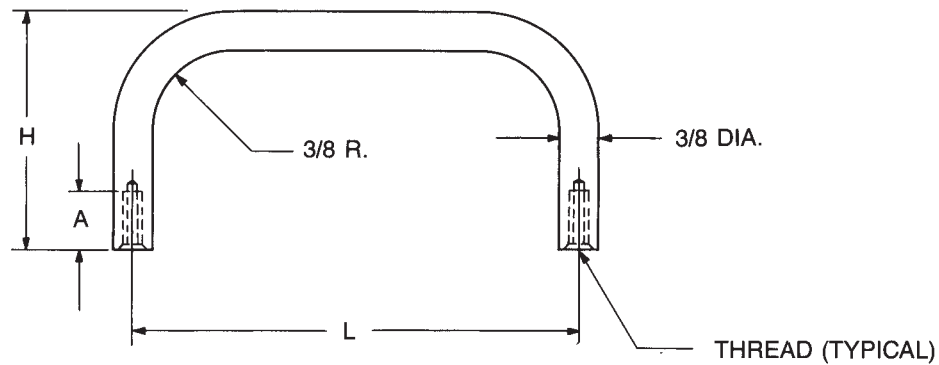

PART NO.	L ± 1/32	H ± 1/32
8214	2"	
8215	3"	
8216	4"	
8217	5"	1-5/16
8218	6"	
8219	7"	
8220	2-1/2	
8221	3"	
8222	4"	
8223	4-1/4	1-1/2
8224	4-1/2	
8225	5"	
8226	6"	
8227	7"	
8228	2"	
8229	2-1/2	
8230	3"	
8231	3-1/2	
8232	4"	
8233	4-1/4	
8234	4-1/2	1-3/4
8235	5"	
8236	5-1/4	
8237	5-1/2	
8238	5-3/4	
8239	6"	
8240	6-1/2	
8241	7"	
8242	3"	
8243	4"	
8244	4-1/4	
8245	4-1/2	1-7/8
8246	5"	
8247	6"	

See page 4H for finish codes  
For non-standard parts contact Sales Office

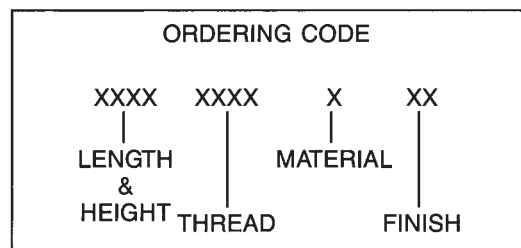

THREAD CODE & DEPTH		
THREAD	CODE	A
8-32	832	7/16
10-32	1032	7/16-5/8
1/4-20	2520	3/8-5/8

MATERIAL	CODE	RoHS
Aluminum	A	YES
Brass	B	YES
Stainless Steel	SS	YES
Steel	S	YES

# MATERIALS

MATERIAL ROD & BAR	ORDERING CODE	MATERIAL SPECIFICATIONS	RoHS COMPLIANT
Aluminum	A	QQ-A-225/8B, QQ-A-200/9D	YES
Aluminum (Ferrules Only)	AL	QQ-A-225/3D, QQ-A-225/6A, QQ-A-225/8B, QQ-A-200/9D	YES
Brass	B	ASTM-B-16	YES
Steel	S	ASTM-A108-07	YES
Stainless Steel	SS	ASTM-A-581, A-582	YES

\* Non RoHS Compliant Finish

## FINISH CODES

*1	Cadmium (Commercial) (Special Order Only)	25	Black Oxide, Brass MIL-F-495E
*2	Cadmium QQ-P-416F-Class 2 (Special Order Only) Type-1 (Clear Chromate)	26	Black Oxide, Stainless Steel, Steel MIL-DTL-13924D, Class 1 and 4
*3	Cadmium QQ-P-416F-Class 2 (Special Order Only) Type-2 (Yellow Chromate)	28	Zinc Plate .0002 ASTM-B-633 (Yellow Chromate)
5	Nickel QQ-N-290 Class 1 Grade G	29	Brushed Finish – Handles Only
*6	Iridite #14 (Gold) MIL-DTL-5541F	30	Brushed Finish – Clear Lacquer – Handles Only
7	Iridite (Clear) MIL-DTL-5541F	31	Brushed Satin – Handles Only
*9	Alodine 1200	32	Brushed Satin – Clear Anodize – Handles Only
10	Chrome QQ-C-320B Class 1 Type I (Bright Finish)	33	Brushed Satin – Black Anodize – Handles Only
11	Chrome QQ-C-320B Class 1 Type II (Satin Finish)	34	Satin Finish – Clear Anodize
12	Zinc .0002 ASTM-B-633 (Clear Chromate)	35	Satin Finish – Black Anodize
19	Caustic Etch	36	Anodize MIL-A-8625F Black High Luster
20	Passivate MIL-F-14072E	38	Polished Nickel – Handles Only
21	Anodize MIL-A-8625F – Type II Class 2 (Sulfuric) Chemical Seal (Dark Grey)	39	Caustic Etch and Lacquer
22	Anodize MIL-A-8625F – Type II Class 1 (Sulfuric) Hot Water Seal (Clear)	40	Semi-Frost Anodize (Clear)
23	Anodize MIL-A-8625F – Type II Class 2 (Sulfuric) Chemical Seal (Yellow Green)	41	Semi-Frost Anodize (Black)
24	Anodize MIL-A-8625F – Type II Class 2 (Sulfuric) Chemical Seal (Black)	45	Passivate QQ-P-35C Type VI
		46	Passivate ASTM A 967 Nitric 1
		47	Passivate ASTM A 380-96
		48	Passivate AMS 2700 Type 2

## DEPTHS OF THREADS

THREAD	BLIND TAP DEPTH
	ALUMINUM, BRASS ST. ST., STEEL
2-56	3/16
4-40	1/4
6-32	3/8
8-32	7/16
10-24	9/16
10-32	9/16
1/4-20	5/8
5/16-18	5/8
3/8-24	5/8

THREADS ARE TO COMMERCIAL 2A AND 2B STANDARDS PER HANDBOOK H-28 (PART I) SCREW THREAD STANDARDS (FEDERAL)

## PERCENTAGE OF THREAD FOR TAPPED HOLES

TAP SIZE	FORM TAP	CUT TAP
2	55	65
4	55	65
6	55	65
8	55	65
10	55	65
1/4	55	65
5/16	60	70
3/8	60	70

THREADS ARE SUPPLIED CUT OR ROLLED AT OUR OPTION UNLESS SPECIFICALLY NOTED ON ORDER.