



Heyco® Original Strain Relief Bushings

Right Angle for Flat Cables



WILL FIT THESE CABLES				PANEL DIMENSIONS				PART NO.		DESC		PART DIMENSIONS				Mounting Hole Plug
UL Type	AWG/ Conductors	Approximate Size		A		B		Finished Fit Panel Thickness*		Black		C		D		PART NO.
		in.	mm.	in.	mm.	in.	mm.	in.	mm.			in.	mm.	in.	mm.	
SPT-1	18/2	.12x.22	3,0x5,6	.437	11,1	.390	9,9	.062	1,6	1354	SR 13-1	.234	5,9	.500	12,7	2488
SPT-1	18/3	.12x.30	3,0x7,6													
SPT-2	18/2	.15x.28	3,8x7,1	.500	12,7	.450	11,4	.040	1,0	1361	SR 14A-1	.390	9,9	.687	17,5	2491
HPN	16/2	.16x.30	4,1x7,6													
Same as SR 14A-1 above except								.100	2,5	1364	SR 14-1	.390	9,9	.687	17,5	2491
SPT-2 & HPN	18/3	.15x.40	3,8x10,2													
SPT-3 & HPN	18/2	.19x.35	4,8x8,9	.562	14,3	.525	13,3	.125	3,2	1384	SR 16-1	.500	12,7	.859	21,8	2494
HPN	16/3	.20x.37	5,1x9,4													
HPN	16/3	.16x.37	4,1x9,4													
SPT-2	18/3	.15x.40	3,8x10,2													
	16/3	.16x.41	4,1x10,4													
SPT-3	18/2	.19x.35	4,8x8,9	.560	14,2	.730	18,5	.080	2,0	1424	SR 20-1	.406	10,3	.812	20,6	consult Heyco
	18/3	.19x.39	4,8x9,9	**	**	**	**				**					consult Heyco
	16/2	.20x.37	5,1x9,4													
	16/3	.20x.43	5,1x10,9													
Same as SR 20-1 above except								.125	3,2	1434	SR 20L-1	.406	10,3	.812	20,6	consult Heyco
SPT-3	16/2	.20x.37	5,1x9,4													
	16/3	.20x.43	5,1x10,9	.750	19,9	.875	22,2	.125	3,2	1454	SR 23-1	.484	12,3	.937	23,8	consult Heyco
	14/2	.24x.42	6,1x10,7	**	**	**	**				**					consult Heyco
	14/3	.24x.51	6,1x13,0													

Fit 1/2" and 3/4" Electrical Knock-out Hole Sizes

SPT-3	14/2	.24x.42	6,1x10,7													
	14/3	.24x.51	6,1x13,0													
	12/3	.29x.51	7,4x13,0	.875	22,2	.840	21,3	.125	3,2	1464	SR 24-1	.500	12,7	.968	24,6	2509
	12/3	.29x.65	7,4x16,5													
SPT-3, SRD & SRDT	10/3	.32x.66	8,0x16,8	1.093	28,0	1.000	25,4	.062	1,6	1442	SR 21N-2	.734	18,6	1.437	36,5	2717
Same as SR 21N-2 above except								.125	3,2	1440	SR 21-2	.734	18,6	1.437	36,5	2717

Standard color black. Consult Heyco for white and other colors.

*Maximum Panel Thickness. Part has additional clearance. Consult Heyco for your Custom Finished Fit Panel Thickness.

**Use Elongated Mounting Hole.



- Provides the same protection for your power supply cable as the straight-thru type AND...
- **Exits the cable flush against the panel**, saving space and directing the cable parallel to the panel.
- Overcomes space limitations and acts as a back or bottom bumper.
- See page 4-38 for corresponding **Mounting Hole Plugs** which can be used to fill blank/unused Mounting Holes and thus allow for a single panel design for multiple applications.
- Consult Heyco for other wire types and sizes.
- See pages 4-27 & 4-28 for SR assembly tools.
- **See page 4-25 for Quick Specs.**

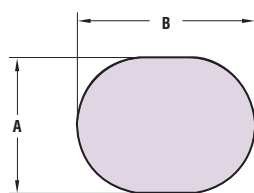
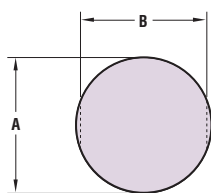

MOUNTING HOLES

