



HEYClean® Brass Pressure Equalization and Drain Plugs

For Pressure Equalization and Drainage Applications

Pressure Equalization Plugs

- Allow the passage of air for ventilation and heat dissipation, yet prevent moisture intrusion.
- Filter membrane prevents moisture and particulate contamination in electronic enclosures.
- Pressure compensating seal prevents buildup of pressure inside of electronic enclosures due to environmental temperature cycling.
- Quick and easy installation into Clearance or Threaded Holes. For Metric Brass Locknuts, see page 3-40.
- Nickel-plated finish over brass provides excellent corrosion resistance and durability.
- Head Thickness: .37" (9,5 mm) to .39" (10 mm).
- Hex shaped body for wrench installation.
- Filter element:
Liquid Tight Membrane: Polyethersulfone (PES)
Sintered Disc: Bronze

Drain Plugs

- Drainage Plugs are ideal for applications where condensation is expected.
- Stainless steel mesh allows water to drain quickly, but protects enclosure from bugs and dust.
- Drainage Plugs feature a cutout section to allow water to completely drain from enclosure, and should be installed at enclosure's lowest point.
- Head Thickness: .37" (9,5 mm) to .39" (10 mm).
- Hex shaped body for wrench installation.

Drain Plug Locknuts

- Quick and easy installation into Clearance Holes only.
- Locknuts feature special cutout to allow water to completely drain from enclosure, when used with HEYClean™ Threaded Drainage Plugs.

| THREAD Type/Size | PART NO. | DESCRIPTION | PART DIMENSIONS | | | | | | | | PROTECTION CLASS |
|---------------------|----------|-------------|---------------------|-----|---------------------|-----|--------------------|-----|----------------------|-----|------------------|
| | | | A Clearance Hole | | B Overall Length | | C Thread Length | | D Wrenching Flats | | |
| | | | in. | mm. | in. | mm. | in. | mm. | in. | mm. | |

Liquid Tight Pressure Equalization Plugs - Ultimate in Liquid Tight Pressure Equalization

| | | | | | | | | | | | |
|-----|------|-----------------|-----|------|-----|------|-----|-----|-----|------|-------------|
| M12 | 4350 | BRASS LTPEP M12 | .47 | 12,0 | .69 | 17,5 | .31 | 8,0 | .71 | 18,0 | IP 66,67,68 |
| M16 | 4351 | BRASS LTPEP M16 | .63 | 16,0 | | | | | | | |
| M20 | 4352 | BRASS LTPEP M20 | .79 | 20,0 | .71 | 18,0 | .31 | 8,0 | .87 | 22,0 | |

Liquid Resistant Pressure Equalization Plugs - Maximize Airflow for Extreme Pressure and Moisture Fluctuations

| | | | | | | | | | | | |
|-----|------|-----------------|-----|------|-----|------|-----|-----|-----|------|------------|
| M12 | 4354 | BRASS LRPEP M12 | .47 | 12,0 | .69 | 17,5 | .31 | 8,0 | .71 | 18,0 | IP 55, x9K |
| M16 | 4355 | BRASS LRPEP M16 | .63 | 16,0 | | | | | | | |
| M20 | 4356 | BRASS LRPEP M20 | .79 | 20,0 | .71 | 18,0 | .31 | 8,0 | .87 | 22,0 | |

Threaded Drain Plug - For Applications Where Condensation Is Expected*

| | | | | | | | | | | | |
|-----|------|---------------|-----|------|-----|------|-----|------|-----|------|-------|
| M12 | 4357 | BRASS TDP M12 | .47 | 12,0 | .69 | 17,5 | .39 | 10,0 | .71 | 18,0 | IP 4x |
| M16 | 4358 | BRASS TDP M16 | .63 | 16,0 | | | | | | | |
| M20 | 4359 | BRASS TDP M20 | .79 | 20,0 | .79 | 20,0 | .39 | 10,0 | .87 | 22,0 | |

Stainless Steel available. Consult Heyco.

*Heyco Drainage Plug Brass Locknuts sold separately

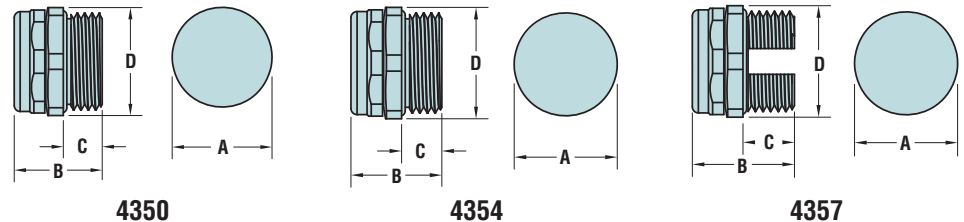

HEYClean® Drain Plug Brass Locknuts

For Use with HEYClean™ Threaded Drainage Plugs

| THREAD Type/Size | PART NO. | DESCRIPTION | PART DIMENSIONS | | | |
|---------------------|----------|----------------|-----------------|-----|----------------------|------|
| | | | A Thickness | | B Wrenching Flats | |
| | | | in. | mm. | in. | mm. |
| M12 | 4360 | BRASS DPLN M12 | .18 | 4,5 | .59 | 15,0 |
| M16 | 4361 | BRASS DPLN M16 | .22 | 5,5 | .75 | 19,0 |
| M20 | 4362 | BRASS DPLN M20 | .22 | 5,5 | .95 | 24,0 |

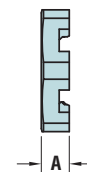
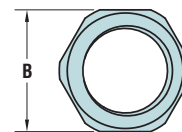

Quick
Specs

| | |
|--------------------|-----------------------------------------------------------------------------------|
| Material | Nickel-Plated Brass |
| Temperature Rating | -40°F (-40°C) to 230°F (110°C) |
| IP Rating | Membrane - IP66/IP68/IP69 Filter Disc - IP55/ IPX9K Drainage Element - IP4X |