



HEYCap™ Tapered Caps and Plugs—NPT

For NPT Fitting Hubs and Threaded Mounting Holes

- HEYCaps can be used as either **caps or plugs**.
- Because they are tapered in design and made from highly flexible polyethylene, they not only **fit snugly** but are readily **removable**.

CAPS:

- Especially recommended for use on **threaded external NPT fitting hubs**.
- Part dimensions are based on average threaded hub fit. Before ordering in quantity, please sample HEYCaps.
- Recommended Closures: Threaded hubs where Cap dimension B is at least 1% smaller than the hub to be capped. Minimum .020 (0,5 mm).

PLUGS:

- Especially recommended for use on **threaded internal NPT fittings and mounting holes**.
- Part dimensions are based on average tapped hole fit. Before ordering in quantity, please sample HEYCap Tapered Plugs.
- Recommended Closures: Threaded mounting holes where Plug dimension A is at least 1% larger than the hole to be plugged. Minimum .020 (0,5 mm).

Fits this NPT Hub or Mounting Hole	PART NO. Red	DESCRIPTION	PART DIMENSIONS							
			A - Major Body Diameters		B - Minor		C Head Diameter		D Depth	
			in.	mm.	in.	mm.	in.	mm.	in.	mm.

HEYCap Tapered Caps* for NPT Fitting Hubs - Body Diameters reference Inside										
1/8	G5014	TCP 49-42†	.42	10,7	.36	9,0	.63	16,0	.38	9,7
1/4	G5020	TCP 61-55	.55	13,8	.47	11,9	.75	19,1	.44	11,2
3/8	G5027	TCP 76-69	.69	17,6	.61	15,6	.88	22,4	.50	12,7
1/2	G5035	TCP 91-85	.85	21,6	.74	18,8	1,06	26,9	.63	16,0
3/4	G5047	TCP 115-108	1,08	27,5	.93	23,7	1,31	33,3	.75	19,1
1	G5057	TCP 136-130	1,30	33,0	1,17	29,8	1,50	38,1	.81	20,6
1-1/4	G5071	TCP 168-162	1,62	41,1	1,50	38,0	1,88	47,8	.75	19,1
1-1/2	G5080	TCP 195-189	1,89	48,0	1,72	43,6	2,13	54,1	1,00	25,4
2	G5096	TCP 246-240	2,40	61,0	2,24	56,8	2,63	66,8	1,00	25,4
2-1/2	G5110	TCP 299-295	2,95	74,9	2,69	68,2	3,13	79,5	1,00	25,4
3	G5116	TCP 356-349	3,49	88,7	3,20	81,3	3,69	93,7	1,13	28,7

HEYCap Tapered Plugs** for NPT Threaded Mounting Holes - Body Diameters reference Outside										
1/8	G5011	TCP 40-33	.40	10,1	.33	8,4	.53	13,5	.38	9,7
1/4	G5014	TCP 49-42†	.49	12,4	.42	10,7	.63	16,0	.38	9,7
3/8	G5022	TCP 63-57	.63	16,0	.55	14,0	.75	19,1	.47	11,9
1/2	G5029	TCP 79-73	.79	20,1	.69	17,5	.94	23,9	.56	14,2
3/4	G5040	TCP 104-98	1,04	26,4	.92	23,4	1,16	29,5	.69	17,5
1	G5048	TCP 122-115	1,22	31,0	1,09	27,7	1,41	35,8	.75	19,1
1-1/4	G5068	TCP 160-154	1,60	40,6	1,51	38,4	1,75	44,5	.50	12,7
1-1/2	G5075	TCP 181-175	1,81	46,0	1,78	45,2	2,00	50,8	.38	9,7
2	G5090	TCP 226-220	2,26	57,4	2,23	56,6	2,50	63,5	.50	12,7
2-1/2	G5106	TCP 279-273	2,79	70,9	2,64	67,1	2,94	74,7	.75	19,1
3	G5115	TCP 346-338	3,46	87,9	3,33	84,6	3,63	92,2	.75	19,1

*May also be used as Plugs: to determine Outside Diameters, add approximately .06" (1,5 mm) to Inside Diameter dimensions.
 **May also be used as Caps: to determine Inside Diameters, subtract approximately .06" (1,5 mm) from Outside Diameter dimensions.
 †Part No. G5014 functions as a Cap for NPT 1/8" Hubs and a Plug for NPT 1/4" Hubs.
 Standard color red.

TAPERED CAP

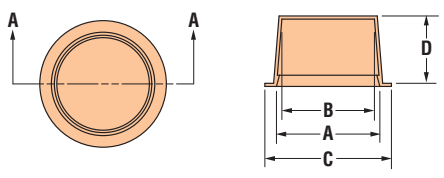

TAPERED PLUG

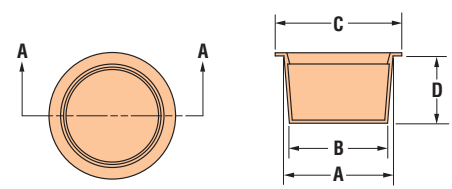

Quick Specs

Material	LDPE
Applicable Specs	Standard Color: Red MIL-C-5501/7 (MIL-C-52078), NAS-835
Maximum Temperature Rating	175°F (79°C)