



Heyco® Feet of Strength

Feet with Snap-In Locking Fingers

- **Snap-in design** eliminates the installation labor needed for a screw or a rivet saving assembly time and equipment.
- Superior mounting approach as the Snap-In Bumper mounts securely into the panel while providing a strong mechanical support to the bumper when used as a mounting foot for electronic enclosures.
- Superior hold versus adhesive backed or screw/rivet bumpers.
- Designed to fit snugly into panel and is dust tight.
- Snap-In Bumpers are skid and scratch resistant and will not mark or stain surfaces.
- Lock firmly into enclosure.
- Quick and easy installation.
- Suitable for metal or plastic panels.
- Bumper constructed of EPDM rubber.

Part Description Key:
 FSSI XX-YY-ZZ where
 XX = Overall Height (inches),
 YY = Mounting Hole Diameter (inches)
 and ZZ = Maximum Panel Thickness (inches)

PART DIMENSIONS				PANEL DIMENSIONS				PART NO. Black	DESCRIPTION		
A Overall Height		B Top Diameter		Mounting Hole Diameter	Thickness Range						
in.	mm.	in.	mm.		in.	mm.		in.	mm.		
FSSI Series											
.19	4,7	.812	20,6	.312	7,9	.03	0,8	.06	1,6	G3016	FSSI 19-31-06
.25	6,3	.812	20,6	.312	7,9	.03	0,8	.06	1,6	G3017	FSSI 25-31-06
.38	9,5	.812	20,6	.312	7,9	.03	0,8	.06	1,6	G3018	FSSI 38-31-06

Standard color black.

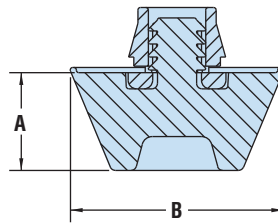

Snap-In

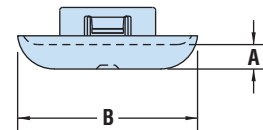

Low Profile Snap-In

- **The low profile snap-in design** requires no screws or adhesives to securely mount into a metal or plastic base.
- The TPE top provides a durable, non-skid surface.
- Snap-In Feet ensure a liquid tight seal and can be used for indoor or outdoor applications.
- Part Description Key:
 LTBP XXX-YYY where
 XXX = Mounting Hole Diameter (inches)
 and YYY = Maximum Panel Thickness (inches)



Low Profile Feet with Snap-In Locking Fingers

PART DIMENSIONS				PANEL DIMENSIONS				PART NO. Black	DESCRIPTION		
A Overall Height		B Top Diameter		Mounting Hole Diameter	Thickness Range						
in.	mm.	in.	mm.		in.	mm.		in.	mm.		
LTBP Series											
.13	3,2	.55	14,0	.500	12,7	.02	0,5	.06	1,6	C2008	LTBP 500-063
						.06	1,6	.25	6,4	C2058	LTBP 500-250
		.66	16,8	.625	15,9	.02	0,5	.06	1,6	C2012	LTBP 625-063
						.06	1,6	.25	6,4	C2062	LTBP 625-250
		.78	19,8	.750	19,1	.02	0,5	.06	1,6	C2016	LTBP 750-063
						.06	1,6	.25	6,4	C2066	LTBP 750-250
		.90	22,9	.875	22,2	.02	0,5	.06	1,6	C2020	LTBP 875-063
						.06	1,6	.25	6,4	C2070	LTBP 875-250
		1.05	26,7	1.000	25,4	.02	0,5	.06	1,6	C2022	LTBP 1000-063
						.06	1,6	.25	6,4	C2072	LTBP 1000-250
		1.16	29,5	1.109	28,2	.02	0,5	.06	1,6	C2024	LTBP 1093-063
						.06	1,6	.25	6,4	C2074	LTBP 1093-250

Standard color black.

Quick Specs

Material	FSSI Series: EPDM Rubber insert, Nylon 6/6 body LTBP Series: Nylon 6/6 and TPE co-molding
Flammability Rating	HB
Temperature Range	-40°F (-40°C) to 221°F (105°C)
IP Rating	IP 67/68 (LTBP only)