

Self-Clinching Flush Nuts

Series CFL

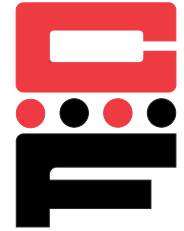

CFL flush nuts offer the advantage of being completely flush within the sheet while providing load-bearing threads in materials too ductile to tap. All dimensions are identical to industry standards.

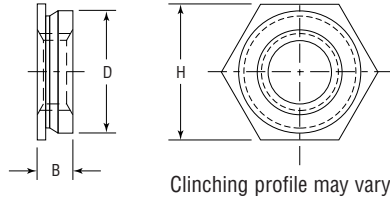

Series	Material	Finish
CFL	300 Series Stainless Steel	Passivated ASTM A967

Thread: Internal 2B, ANSI B1.1 (6H, ANSI/ASME B1.13M)
 Use in: Materials with Rockwell Hardness of B-70 or less.

Dimensions & Specifications

Thread Size	Part Number	D Max.	Min.		H Nom.	B Max.	Min.	
INCH (in.)	#2-56	.171	.060	.172	.188	.060	.23	
			.091					
	#4-40	.171	.060	.091	.172	.188	.060	.23
				.091				
	#6-32	.212	.060	.091	.213	.25	.060	.27
				.091				
	#8-32	.289	.060	.091	.290	.312	.060	.28
				.091				
	#10-24	.311	.060	.091	.312	.343	.060	.31
				.091				
	#10-32	.311	.060	.091	.312	.343	.060	.31
				.091				
	1/4-20	.343	.125	.156	.344	.375	.120	.34
				.187				
.182								
1/4-28	.343	.125	.156	.344	.375	.120	.34	
			.187					
			.182					
METRIC (mm)	M2 x 0.4	4.35	1.53	4.37	4.8	1.53	6.0	
			2.3					
	M2.5 x 4.5	4.35	1.53	2.3	4.37	4.8	1.53	6.0
				2.3				
	M3 x 0.5	4.35	1.53	2.3	4.37	4.8	1.53	6.0
				2.3				
	M3.5 x 0.6	5.35	1.5	2.3	5.4	6.4	1.53	6.5
				2.3				
	M4 x 0.7	7.35	1.53	2.3	7.37	7.9	1.53	7.2
				2.3				
	M5 x 0.8	7.9	1.5	2.3	7.92	8.7	1.53	8.0
				2.3				
	M6 x 1.0	8.72	3.18	3.96	8.74	9.5	3.05	8.8
				4.75				
3.84								





Self-Clinching Flush Nuts

Series CFL

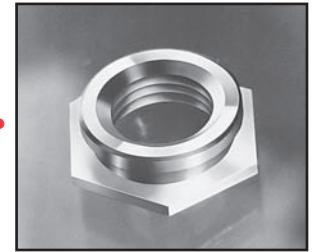

Continued from previous page.

Installation & Performance Data

		Cold-rolled Steel		5052-H34 Aluminum	
Part Number	Max. Screw torque (in.-lbs.)	Installation Force (lbs.)	Pushout (lbs.)	Installation Force (lbs.)	Pushout (lbs.)
		Installation Force (kN)	Pushout (kN)	Installation Force (kN)	Pushout (kN)
INCH (in.)	CFL256-1	3000	200	2000	200
	CFL256-2	3000	200	2000	200
	CFL440-1	3000	200	2000	200
	CFL440-2	3000	200	2000	200
	CFL632-1	3000	200	2000	200
	CFL632-2	3000	200	2000	200
	CFL832-1	4000	240	2000	240
	CFL832-2	4000	240	2000	240
	CFL1024-1	4000	240	4000	240
	CFL1024-2	4000	240	4000	240
	CFL1032-1	4000	240	4000	240
	CFL1032-2	4000	240	4000	240
	CFL420-3,4,5	4500	840	3500	640
	CFL428-3,4,5	4500	840	3500	640
METRIC (mm)	CFLM2-1	13.3	.890	8.9	.890
	CFLM2-2	13.3	.890	8.9	.890
	CFLM2.5-1	13.3	.890	8.9	.890
	CFLM2.5-2	13.3	.890	8.9	.9
	CFLM3-1,2	13.3	.890	8.9	.890
	CFLM3.5-1,2	15	1.0	8.9	.9
	CFLM4-1,2	17.8	1.068	17.8	1.068
	CFLM5-1,2	17.8	1.068	17.8	1.068
	CFLM6-3,4,5	20	3.736	20	3.736

