

# Magna-Grip®

Offering a wide grip range and uniform installed values.

In applications where a wide grip range is required and a flush pin break to the collar is beneficial, Huck Magna-Grip® is the ideal fastener for the job. In fact, Magna-Grip's wide grip range can replace up to 4 traditional HuckBolts.

Like all Huck engineered fasteners, Magna-Grip offers the highest level of vibration resistance possible. Magna-Grip installs reliably, and consistently provides high, uniform installed values.

**Available Sizes:**

3/16", 1/4", 5/16", 3/8"

**Materials:**

Steel, Aluminum

**Headstyles:**

Button, Truss, Broad Truss, 90° Flush, 98T



## Secure, Fast Installation

1. Flush-breaking, lock-groove design provides a wide grip range to reduce inventory requirements.
2. Collar material swaged into the annular pin grooves forms a permanent, vibration-proof connection that promotes increased customer satisfaction and reduced warranty claims.
3. Hole preparation isn't critical. Built-in system values yield high, consistent clamp loads, and gap removal.

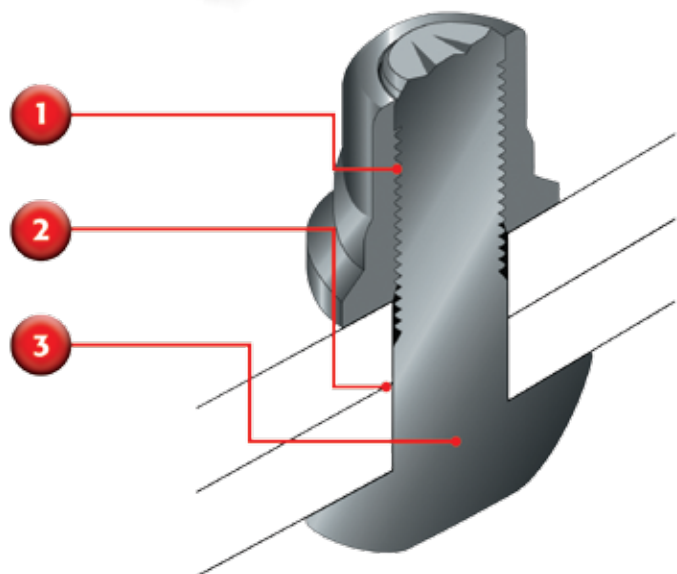

## Magna-Grip Head Style Options

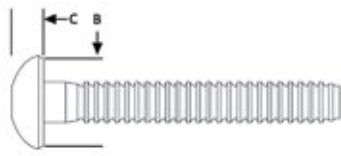

Button

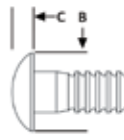

98T

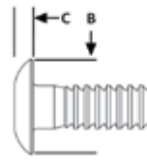

Truss

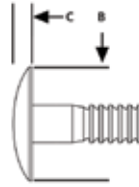

Broad Truss

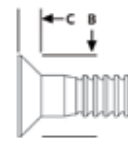

90 Degree Flush

## Steel Pin - Zinc Plated

Diameter	Part No.	Grip Range	Max Hole Size	[B] Head Dia (max)	[C] Head Height (max)	Typical Shear (lbs)	Typical Clamp (lbf)	Typical Tensile (lbs)
<b>Button Head</b>								
3/16"	MGPB-R6-10G	.062-.625	.219	.395	.129	2000	1500	2700
	MGPB-R6-20G	.312-1.250	.219	.395	.129	2000	1500	2700
1/4"	MGPB-R8-10G	.062-.625	.281	.520	.154	2700	2000	4000
	MGPB-R8-20G	.312-1.250	.281	.520	.154	2700	2000	4000
5/16"	MGPB-R10-12G	.125-.750	.359	.655	.206	3900	2900	6200
	MGPB-R10-22G	.625-1.375	.359	.655	.206	3900	2900	6200
3/8"	MGPB-R12-14G	.125-.875	.422	.780	.250	6000	4000	9000
	MGPB-R12-26G	.750-1.625	.422	.780	.250	6000	4000	9000
<b>98T Head</b>								
3/16"	MGP98T-R6-10G	.062-.625	.219	.488	.105	2000	1500	2700
	MGP98T-R6-10GP	.062-.625	.219	.488	.105	2000	1500	2700
	MGP98T-R6-20G	.312-1.250	.219	.488	.105	2000	1500	2700
<b>Truss Head</b>								
1/4"	MGPT-R8-10G	.062-.625	.281	.582	.120	2700	2000	4000
	MGPT-R8-10GP	.062-.625	.281	.582	.120	2700	2000	4000
	MGPT-R8-20G	.312-1.250	.281	.582	.120	2700	2000	4000
5/16"	MGPT-R10-12G	.125-.750	.359	.802	.149	3900	2900	6200
3/8"	MGPT-R12-14G	.125-.875	.422	.905	.175	6000	4000	9000
<b>Broad Truss Head</b>								
1/4"	MGP30-R8-10G	.062-.625	.281	.978	.165	2700	2000	4000
	MGP30-R8-24G	.062-1.500	.281	.978	.165	2700	2000	4000
3/8"	MGP30-R12-24G	.625-1.500	.422	1.259	.215	6000	4000	9000
	MGP30-R12-32G	1.125-2.000	.422	1.259	.215	6000	4000	9000
<b>90° Flush Head</b>								
3/16"	MGP90-R6-10G	.062-.625	.219	.361	.105	2000	1500	2700
1/4"	MGP90-R8-10G	.062-.625	.281	.475	.130	2700	2000	4000

NOTE: Part number listings reflect typical stock. Items not listed require a minimum order.



## Steel Pin - Cadmium Plated

Diameter	Part No.	Grip Range	Max Hole Size	[B] Head Dia (max)	[C] Head Height (max)	Typical Shear (lbs)	Typical Clamp (lbf)	Typical Tensile (lbs)
<b>Button Head</b>								
3/8"	MGPB-R12-14C	.125-.875	.422	.780	.250	6000	4000	9000
<b>98T Head</b>								
3/16"	MGP98T-R6-10C	.062-.625	.219	.488	.108	2000	1500	2700

## Steel Pin - Zinc Plated - Stainless Steel Cap

Diameter	Part No.	Grip Range	Max Hole Size	[B] Head Dia (max)	[C] Head Height (max)	Typical Shear (lbs)	Typical Clamp (lbf)	Typical Tensile (lbs)
<b>Truss Head</b>								
1/4"	MGPTC-R8-10G	.062-.625	.281	.582	.120	2700	2000	4000
3/8"	MGPTC-R12-14G	.125-.875	.422	.905	.210	6000	4000	9000

## Aluminum Pins

Diameter	Part No.	Grip Range	Max Hole Size	[B] Head Dia (max)	[C] Head Height (max)	Typical Shear (lbs)	Typical Clamp (lbf)	Typical Tensile (lbs)
<b>Button Head</b>								
3/16"	MGPB-E6-10	.062-.625	.219	.395	.129	1000	800	1300
1/4"	MGPB-E8-10	.062-.625	.281	.520	.154	1600	1400	2500
	MGPB-E8-20	.312-1.250	.281	.520	.154	1600	1400	2500
5/16"	MGPB-E10-12	.125-.750	.359	.655	.206	2700	2200	4100
3/8"	MGPB-E12-14	.125-.875	.422	.780	.250	3900	3200	5500
<b>98T Head</b>								
3/16"	MGP98T-E6-10	.062-.625	.219	.488	.108	1000	800	1300
	MGP98T-E6-20	.312-1.250	.219	.488	.108	1000	800	1300
<b>Truss Head</b>								
1/4"	MGPT-E8-10	.062-.625	.281	.582	.120	1600	1400	2500
<b>Broad Truss Head</b>								
3/8"	MGP30-E12-24	.625-1.500	.422	1.259	.215	3900	3200	5500
<b>90° Flush Head</b>								
3/16"	MGP90-E6-10	.062-.625	.219	.361	.105	1000	800	1300
1/4"	MGP90-E8-10	.062-.625	.281	.475	.130	1600	1400	2500

NOTE: Part number listings reflect typical stock. Items not listed require a minimum order.



## Magna-Grip Lockbolt Collars

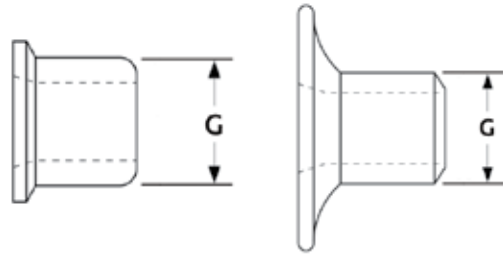

Flanged

Wide-Flanged

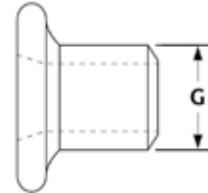

Medium-Flanged

	Diameter	Part No.	Width(G)
<b>Steel - Zinc Plated</b>			
Flanged	3/16"	MGC-R6U	.305-.315
	1/4"	MGC-R8U	.395-.405
	5/16"	MGC-R10U	.500-.510
	3/8"	MGC-R12U	.602-.612
Medium Flange	3/16"	MGCS-R6U	.305-.315
Wide Flange	3/16"	MGCW-R6U	.305-.315
	1/4"	MGCW-R8U	.395-.405
<b>Steel - Cadmium Plated</b>			
Flanged	3/16"	MGC-R6C	.305-.315
	1/4"	MGC-R8C	.395-.405
	3/8"	MGC-R12C	.375-.385
<b>Aluminum</b>			
Flanged	3/16"	MGC-F6	.305-.315
	1/4"	MGC-F8	.395-.405
	5/16"	MGC-F10	.500-.510
	3/8"	MGC-F12	.602-.612
Wide Flange	3/16"	MGCW-F6	.305-.315

## Magna-Grip Installation Tooling

Diameter	Installation Tool	Nose Assembly	Type
3/16"	2024	99-3201	Pneudraulic
	2025	99-3201	Pneudraulic
	255	99-3206	Pneudraulic
	256	99-3206	Pneudraulic
	2480	99-3201	Hydraulic
	2580	99-3206	Hydraulic
1/4"	2024	99-3204	Pneudraulic
	2025	99-3204	Pneudraulic
	255	99-3207	Pneudraulic
	256	99-3207	Pneudraulic
	2480	99-3204	Hydraulic
	2580	99-3207	Hydraulic
5/16"	255	99-1439	Pneudraulic
	256	99-1439	Pneudraulic
	2580	99-1439	Pneudraulic
	2600	99-3217	Pneudraulic
3/8"	255	99-1440*	Pneudraulic
	256	99-1440	Pneudraulic
	2580	99-1440	Hydraulic
	2600	99-3220	Hydraulic
	2620PT	H99-1492	Hydraulic

\* Aluminum Only

