

# Industrial Applications Specialty Slide Products



## Specialty Slide Products

This group of products offers singular features with broad appeal in a host of applications such as manufacturing machinery, diagnostic equipment, and much more.

## Specifications at a Glance

Model	Max. Load Capacity	Travel	Cross Section Width	Detent or Lock	Disconnect	Page
38EL	100 lbs. [45 kg]	Full	.50" [12.7]	Lock	Lever	28
10EL	N/A	—	.47" [12.0]	Lock	N/A	28
CB-HAND	Dependent on slide	—	—	Lock-in/ Lock-out	None	29
115RC	265 lbs. [120 kg]	Linear	.48" [12.3]	None	None	30
Ascent CBLift-0019	14.5 lbs. [6.6 kg]	21" [538 mm]	—	—	None	31
115	Determined by mounting	Linear	.43" [11.1]	None	None	32
SS2028	100 lbs. [45 kg]	3/4	.38" [9.6 mm]	Hold-in	None	32
SS0330	143 lbs. [65 kg]	Full	.75" [19.1 mm]	Hold-in	None	33
SS5321	352 lbs. [160 kg]	Over	.75" [19.1 mm]	Hold-in	None	33

# Industrial Applications Specialty Slide Products



## 38EL & 10EL Low Voltage Electronic Locking Hardware

*These products offer easy-to-install, yet advanced methods to secure and control access to openings and components or assemblies in a wide range of industrial applications.*



**Model 38EL**

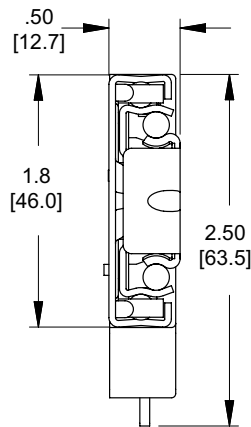

**Model 38EL**

### Common Features

- Two options available:
  - Lock/Unlock – Opened manually
  - Kick-Out – Propels doors/drawers open about 2 inches when unlocked.
- Sensor feedback indicates open or closed status and locked or unlocked status
- Lock mechanism withstands up to 150 pounds of force and includes a provision to connect a manual override.
- Lock is low voltage and operates with minimal power consumption using any power source supplying 5 to 30 VDC.
- These products are compatible with a number of third-party components to facilitate activation and integration into existing systems.

### Model 38EL-Slide with Integrated Lock

- Full extension with integrated electronic locking mechanism
- Eliminates the need to install add-on locks—saving time and increasing productivity while reducing components, sourcing time, and inventory management.
- Full extension provides complete access to drawer contents.
- Load capacity up to 100 pounds per pair.
- Slide and integrated locking device occupy .50" side space.
- Slide: clear zinc finish
- Lengths: 14"–28" in 2" increments.

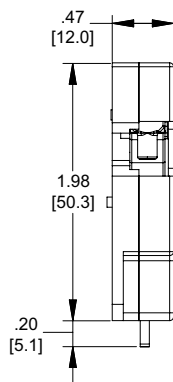

**Model 10EL**

### Model 10EL-Lock Only

- Stand-alone electronic lock used to secure smaller doors and other openings.
- Includes an installation jig designed to locate the lock and catch positions to speed and simplify installation.
- Lock/exterior finish: Zinc and black polymer.

### Optional Accessories

#### P/N CBLEL-60

*6' cable with lock connector and tinned ends.*



# Industrial Applications Specialty Slide Products



## CB-Hand Locking Handle Kit

Adds lock-in and lock-out features to heavy-duty drawers or trays. Suitable for installations where the locking feature provides a measure of safety.

- Compatible with models 7950, 7957, 9301, and other slides with cross sections .75" [17.5 mm] or greater.
- Accommodates drawers up to 60" (1.5 m) wide.
- Activates with a centrally located push-button.
- Two locking options:
  - Front mounted unit – lock-in only (CBHAND-2)
  - Rear mounted unit – lock-in and lock-out (CBHAN4-5)
- Connecting rod not included
- Lock-out not intended for use with over travel slides
- Cut-to-length stainless steel rods allow for varying drawer widths (ordered separately).
- Lightweight and corrosion resistant components

### Optional Kits

#### CBHAN4-5

Lock-out conversion kit

#### CBHAN3-0100-2

2 ea. 19.7" [500 mm] Stainless Steel Rods

#### CBHAN3-0150-2

2 ea. 29.5" [750 mm] Stainless Steel Rods

**NOTE:** The addition of the lock-out kit requires an additional threaded bar (not included). See product technical sheet for details.

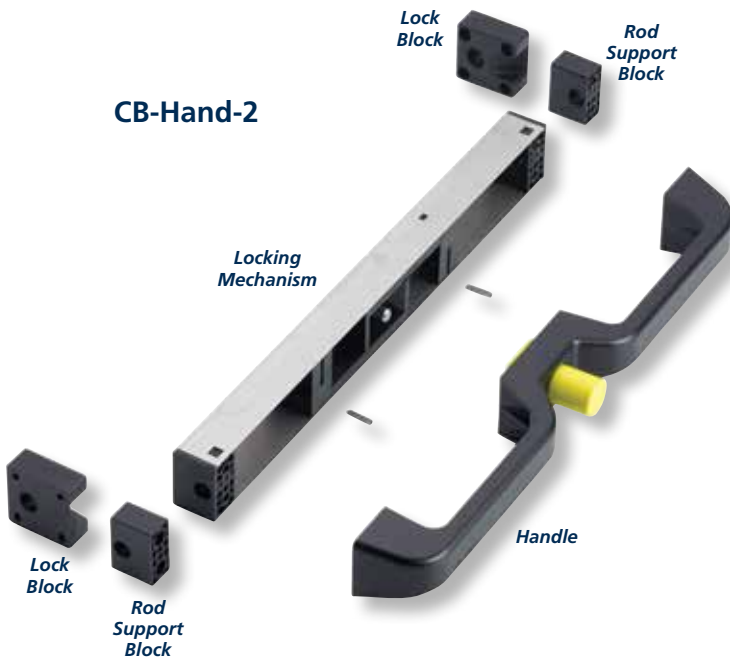

CB-Hand-2

Locking Mechanism

Handle

Lock Block

Lock Block

Rod Support Block

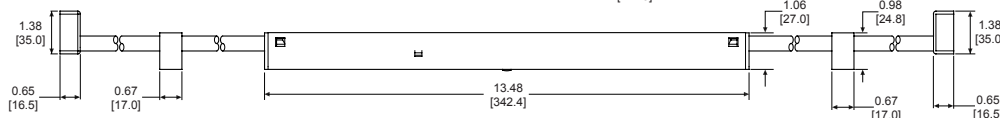
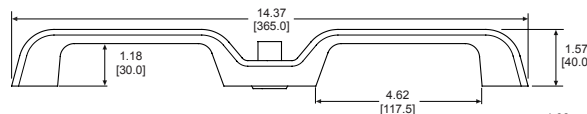
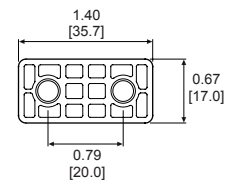
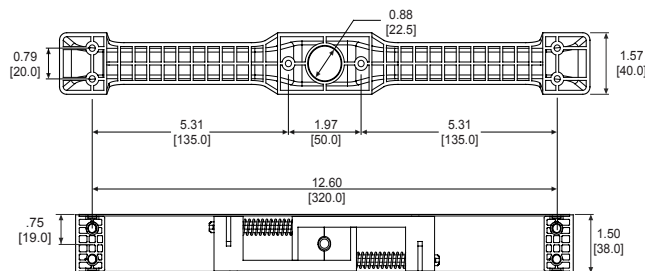
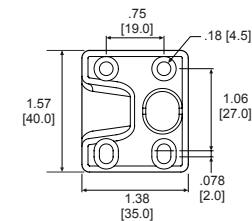

# Industrial Applications Specialty Slide Products



## 115RC

A simple motion solution comprised of aluminum tracks and re-circulating ball carriages. Use for movement and positioning of screens, panels, boards, or components used in medical apparatus.

### Features

- Load rating up to 265 lbs. [120 kg]
- Load capacity based on track orientation and the type of ball carriages
- Corrosion-resistant components

### Aluminum Track

- Available in two lengths: 47" [1.2 m] and 94" [2.4 m].
- Track may be cut down to the desired length or butted together to extend to greater lengths.
- Track may be side, flat, or vertically mounted.
- Flat-mounted track may be oriented with ball carriage facing up or down.
- Tracks have drilling marks for fixing holes and end stops.

### Ball Carriages

- Re-circulating ball carriages in two options:
  - Stainless steel ball bearings
  - Polymer ball bearings
- Multiple carriages may be inserted into tracks. Carriages may be used separately to provide independent movement, combined as a unit, or both methods within one track.

### Optional Kits

#### DZ0115-DJIGRC

Drill Jig (made to order)

### Load Ratings

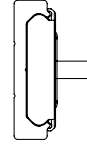

Side mount

SS0115-CASSRC Stainless Steel Ball Carriage	CB0115-CASSRC Polymer Ball Carriage
x1 110 lbs.	x1 65 lbs.
x2 200 lbs.	x2 120 lbs.
x3 265 lbs.	x3 160 lbs.

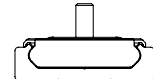

Flat mount  
(carriage up)

SS0115-CASSRC Stainless Steel Ball Carriage	CB0115-CASSRC Polymer Ball Carriage
x1 65 lbs.	x1 40 lbs.
x2 120 lbs.	x2 70 lbs.
x3 155 lbs.	x3 90 lbs.

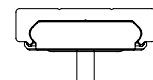

Flat mount  
(carriage down)

SS0115-CASSRC Stainless Steel Ball Carriage	CB0115-CASSRC Polymer Ball Carriage
x1 90 lbs.	x1 50 lbs.
x2 155 lbs.	x2 90 lbs.
x3 200 lbs.	x3 120 lbs.

**NOTE:** Weight should be evenly distributed across the carriage(s).

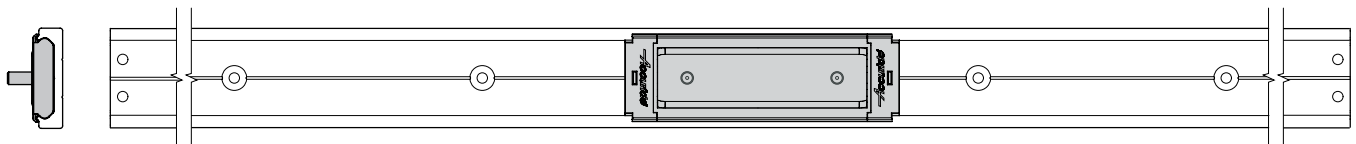
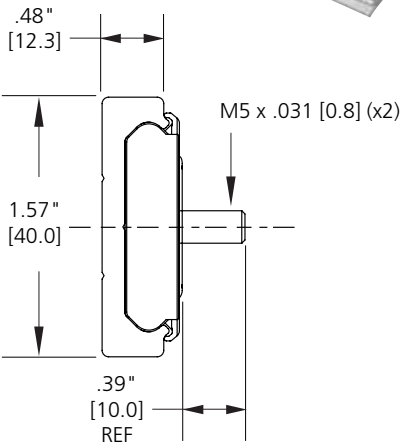

#### Note:

Due to the extensive variety of applications and possible orientations for this product, we recommend that customers first test this product in the intended application. This product is not recommended for high-torque applications.





## Ascent CBLift-0019

*The Ascent is a push-to-operate mechanical lift that provides access and conceals screens in desks and other cabinetry when not in use.*

- Accommodates screens from 5.5–14.5 pounds [2.5–6.6 kg], up to 17.5 inches tall, and 22 inches diagonally
- No power required; movement is controlled by counterbalancing weights
- Swivels  $\pm 112.5^\circ$  for expanded viewing access
- Easy to install
- Unit raises 21 inches in less than 2 seconds
- Packaging includes wire management, cable control kit, and one weight pack
- Black electroplate finish

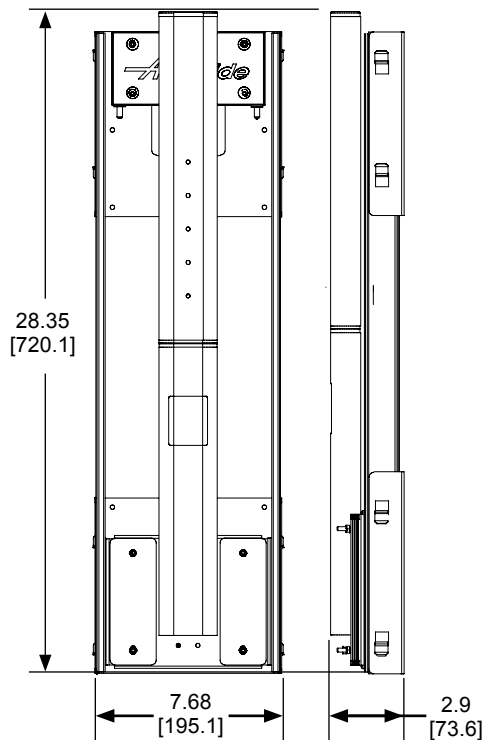

Optional  
VESA  
Fixed  
Bracket

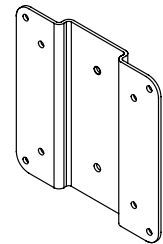

Optional  
VESA  
Tilt  
Bracket

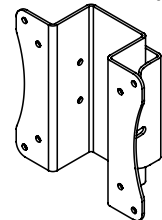

### Optional Kits

**Additional Weight Pack**  
(3.88 oz. [10X] plates)  
P/N 2990-9774-BE

**Weight Extension Plate Kit**  
P/N 2990-9775-BE

**VESA Tilt Bracket**  
P/N 2990-9776-BE

**VESA Fixed Bracket**  
P/N 2990-9777-BE

*The slim and compact design makes the Ascent a multi-purpose solution for a wide range of applications in industrial, commercial, institutional, and manufacturing environments.*



# Industrial Applications Specialty Slide Products

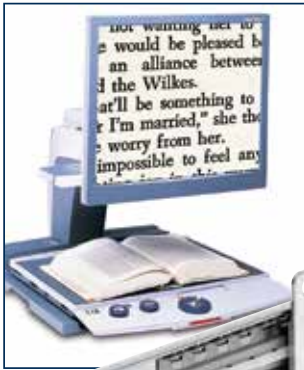

## 115

Model 115 is a linear motion ball bearing slide designed for component guidance, support, or adjustment in applications from manufacturing machinery to utility vehicles to diagnostic equipment.

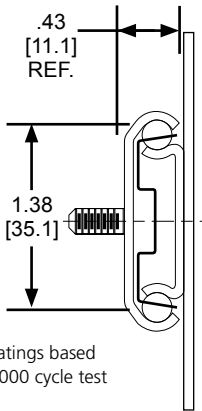

\* Load ratings based on 10,000 cycle test

- Load ratings:  
Flat mount – up to 132 lbs. [60 kg]/pair  
Side mount – up to 110 lbs. [50 kg]/pair
- May be mounted vertically as a non-load bearing guide
- .43" [11 mm] width, 1.38" [35.1 mm] height
- Non-disconnect
- Provides captive motion within the length of the outer member
- A guide belt synchronizes the moving elements of the slide for smooth and consistent travel
- Moving member is fully supported on ball bearings
- Lengths: 12"–28" in 2" increments, plus 32", 36", and 40" [305–711 mm, 813 mm, 914 mm, 1016 mm]

Slide Length	Slide Travel	Load Rating Lbs./Pr. Flat	Load Rating Lbs./Pr. Side
12.00 [305]	8.90 [226]	132 [60]	110 [50]
14.00 [356]	10.87 [276]	132 [60]	110 [50]
16.00 [406]	12.87 [327]	132 [60]	110 [50]
18.00 [457]	14.88 [378]	132 [60]	110 [50]
20.00 [508]	16.89 [429]	132 [60]	110 [50]
22.00 [559]	18.90 [480]	132 [60]	110 [50]
24.00 [610]	20.87 [530]	132 [60]	110 [50]
26.00 [660]	22.87 [581]	132 [60]	110 [50]
28.00 [711]	24.88 [632]	132 [60]	110 [50]
32.00 [813]	28.90 [734]	132 [60]	110 [50]
36.00 [914]	32.87 [835]	132 [60]	110 [50]
40.00 [1016]	36.79 [937]	132 [60]	110 [50]



## SS2028

Stainless steel for corrosion resistance in applications such as food or chemical storage.



**Stainless Steel**

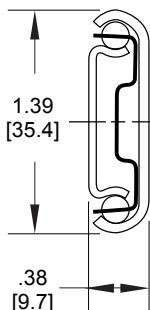

- Load capacity up to 100 lbs. [45 kg]/pair\*
- 3/4 extension
- Corrosion resistant
- Hold-in detent
- .38" [9.5 mm] side space
- Non-disconnect
- Even lengths 12"–28" [300–700 mm]\*\*
- Food-safe grease available by special order

Slide Length	Slide Travel
11.81 [300]	8.23 [209]
13.78 [350]	9.64 [245]
15.75 [400]	11.10 [282]
17.72 [450]	12.60 [320]
19.69 [500]	14.06 [357]
21.65 [550]	15.51 [394]
23.62 [600]	17.00 [432]
25.59 [650]	18.46 [469]
27.56 [700]	19.92 [506]

\* Load rating based on 18" slides in an 18" wide drawer cycled 80,000 times

\*\* The lengths indicated in inches are approximate conversions from the metric measurements. Please see the chart above or the product technical sheet



# Industrial Applications Specialty Slide Products



## SS0330

*Stainless steel and full extension for applications subject to moisture or humidity.*

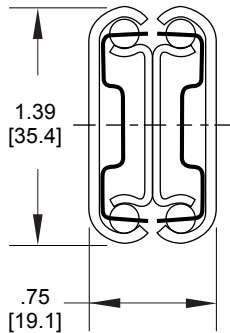

- Load capacity up to 143 lbs. [65 kg]/pair\*
- Full extension
- Corrosion resistant
- Hold-in detent
- .75" [19.1mm] side space
- Non-disconnect
- Available in even lengths 12"-24" [300-600 mm], plus 28" [700 mm]\*\*
- Food-safe grease available by special order

Slide Length	Slide Travel	Load Rating Lbs./Pr.
11.81 [300]	11.98 [304.5]	110 [50]
13.77 [350]	13.93 [354]	121 [55]
15.74 [400]	15.86 [403]	121 [55]
17.71 [450]	17.79 [452]	143 [65]
19.68 [500]	19.72 [501]	121 [55]
21.65 [550]	22.67 [550.5]	110 [50]
23.62 [600]	23.62 [600]	99 [45]
27.55 [700]	27.48 [698]	77 [35]

Slide Length	Slide Travel	Load Rating Lbs./Pr.
11.81 [300]	12.74 [323.5]	264 [120]
13.78 [350]	14.70 [373.5]	286 [130]
15.75 [400]	16.67 [423.5]	308 [140]
17.72 [450]	18.64 [473.5]	330 [150]
19.68 [500]	20.61 [523.5]	352 [160]
21.65 [550]	22.58 [573.5]	330 [150]
23.62 [600]	24.55 [623.5]	286 [130]
27.56 [700]	28.48 [723.5]	242 [110]
31.10 [790]	31.63 [803.5]	220 [100]



## SS5321

*Stainless steel offers corrosion resistance for applications exposed to moisture such as marine or industrial storage.*

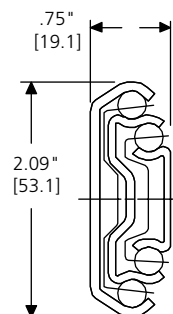

- Load capacity up to 352 lbs. [160 kg]/pair\*
- 1" [25.4 mm] over travel
- Corrosion resistant
- Hold-in detent
- .75" [19.1mm] side space
- Non-disconnect
- Available in even lengths 12"-24", 28", 31" [300-600, 700, 790 mm]\*\*
- Food-safe grease available by special order

\* Load rating based on 18" slides in an 18" wide drawer cycled 80,000 times

\*\* The lengths indicated in inches are approximate conversions from the metric measurements. Please see the chart above or the product technical sheet for exact dimensions.