



MODEL 38EL

Electronic Lock Slide
100-lb. load rating
Integrated locking mechanism



APPLICATIONS: Provides an easy-to-install method to secure and control access to drawers. **This product is covered by U.S. (8,328,299), and various patents pending.**

38EL QUICK REFERENCE

Side Space: .5" + 0.031" x 2
Lengths: 14"–28"
Height: 1.80"
Load: 100-lb.*

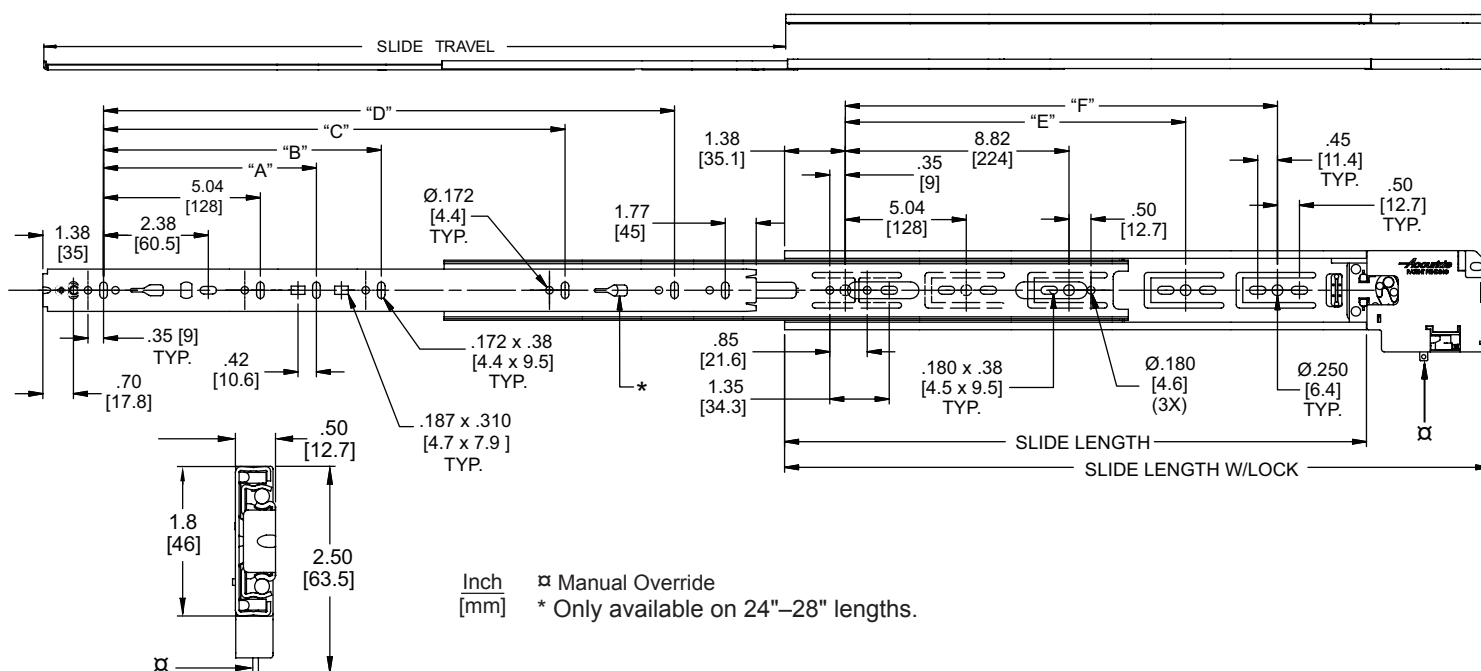

Finish: Clear electroplate(C)

Lengths: 14"–28" [350 mm–700 mm]

Note: cabinet depth must include an additional 3" to allow room for the locking mechanism and wiring at the back of the slide.

Load Rating: Up to 100 lbs. [45.5 kg] per pair*

Travel: Full extension

Disconnect: Handed lever disconnect

Height: 1.80" [45.7mm]

Height w/Lock: 2.50" [63.5mm]

Side Space: .50" +0.031/-0.0 [12.7mm +0.8/0.0

Mounting

Hardware: #8 pan head screw

Features: Electronic locking mechanism with manual override. Lock withstands up to 150 pounds of force.

Cables: 12" cable

Options: Lock/Unlock (opened manually)
Kick-out (propelled open about 2" when unlocked)
Kick-out action works best with auto-lock feature, which is controlled through activation device

Part Number	Slide Length	Length w/Lock	Travel	"A"	"B"	"C"	"D"	"E"	"F"
C38EL-XX14P	13.78 [350]	16.58 [421]	14.00 [356]						
C38EL-XX16P	15.75 [400]	18.55 [471]	16.00 [406]						12.60 [320]
C38EL-XX18P	17.72 [450]	20.52 [621]	18.00 [457]			12.60 [320]			13.86 [352]
C38EL-XX20P	19.68 [500]	22.48 [571]	20.00 [508]			12.60 [320]			16.38 [416]
C38EL-XX22P	21.65 [550]	24.45 [621]	22.00 [559]			12.60 [320]	16.38 [416]	13.86 [352]	17.64 [448]
C38EL-XX24P	23.62 [600]	26.42 [671]	24.00 [610]	8.82 [224]		16.38 [416]		13.86 [352]	18.90 [480]
C38EL-XX26P	25.59 [650]	28.39 [721]	26.00 [660]	8.82 [224]		16.38 [416]	21.42 [544]	13.86 [352]	21.42 [544]
C38EL-XX28P	27.56 [700]	30.36 [771]	28.00 [711]	8.82 [224]	11.34 [288]	16.38 [416]	21.42 [544]	13.86 [352]	21.42 [544]



1-800-453-1692

www.aboveboardelectronics.com

* Load rating based on 18" slides mounted in a 16" wide drawer cycled 50,000 times.



WARNING! Before installing the drawer, you must have access to the lock's manual override lever or the activation device must be connected and working properly. **Otherwise, you will not be able to unlock the slide and open the drawer.**

IMPORTANT:

- Be sure the interior cabinet depth allows for an additional 3" beyond the length of the slide to provide room for the locking mechanism and wiring (Figure 1). See the chart below for minimum cabinet depth. For inset drawers, be sure to provide sufficient cabinet depth to allow slide setback.

Length	Min. Cabinet Depth
16"	19"
18"	21"
20"	23"
22"	25"

- Slides will not function properly if side space is less than .50" [12.7 mm]. For optimum performance, construct drawer 1-1/16" [27.0 mm] smaller than the opening of the cabinet.

Figure 1. 38EL Components and Interior Cabinet Depth

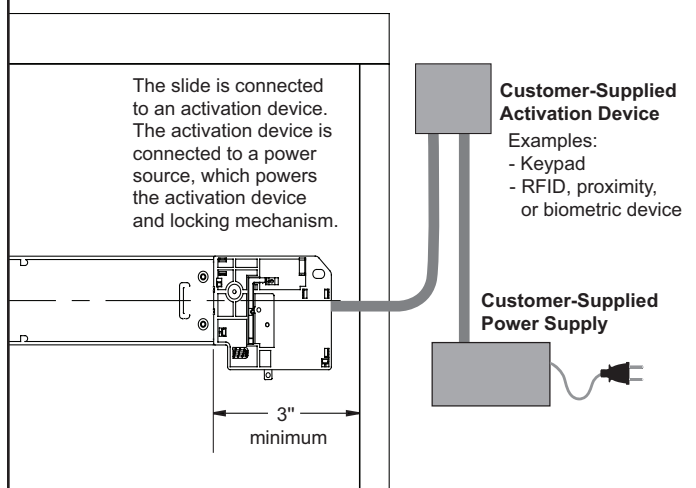

Slide Installation

Install Cabinet Member

1. Separate the slide members by first actuating the manual override located on the locking mechanism.
2. Then, lift the disconnect lever to release the inner (drawer) member.
3. Overlay drawer front:
 - Conventional mounting, see Figure 2.
 - 32 mm system mounting, see Figure 3.

Figure 2. Conventional mounting - Cabinet

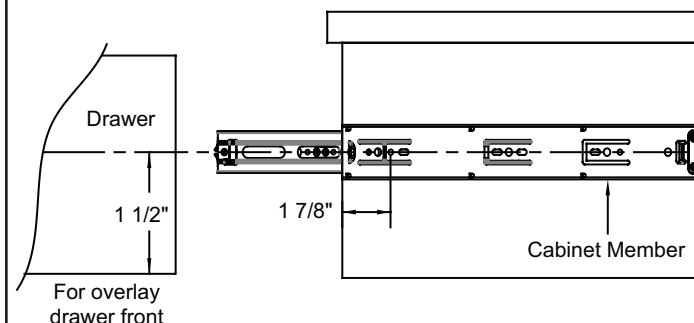
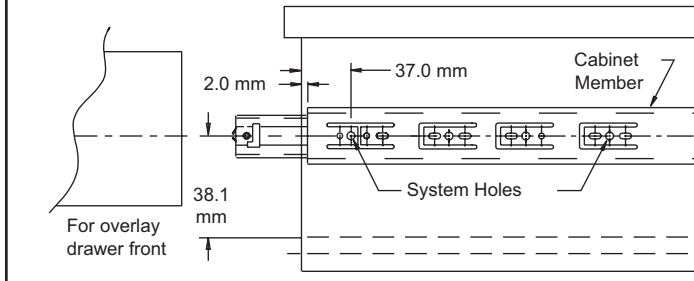

Figure 3. 32 mm system mounting - Cabinet



4. Inset drawer front:
Slide setback is the thickness of the drawer front plus 1/8" [3.2 mm].
5. Use only the 32 mm system holes or the wood screw holes located at the tip of the breathing tabs. Do not use any other holes on the cabinet member for mounting (Figure 4).

Figure 4. Cabinet Member Fastener Locations

Use all mounting tabs to achieve load rating.

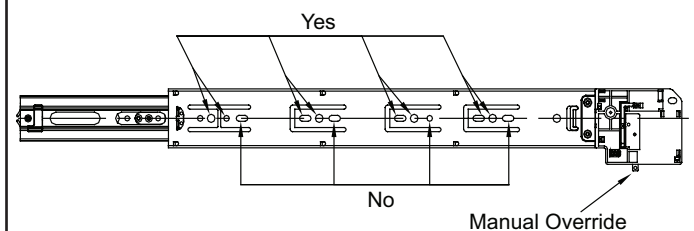

Install Drawer Member

1. See Figure 5 for drawer member setback.
2. Install the drawer member with a screw through the cam adjuster and a screw through a hole or slot at the rear (see Figure 5).

Figure 5. Conventional Mounting and 32 mm Mounting - Drawer

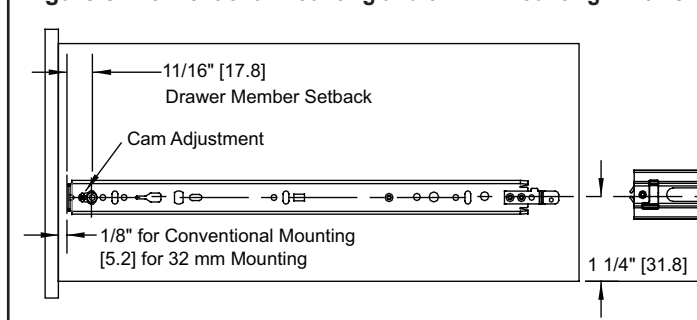

Drawer Insertion and Adjustment



WARNING! Before installing the drawer, you must have access to the lock's manual override lever or the activation device must be connected and working properly. Otherwise, you will not be able to unlock the slide and open the drawer.

1. Make sure the ball bearing retainers in the cabinet are fully forward. Install drawer into cabinet and close the drawer.
2. Install additional screws to secure.

Technical Data

For examples of how activation devices may be connected to the 38EL, see the Activation Device sheet on our website at: <http://www.accuride.com/Resources/PDF/EL-Activation.pdf>

Power Requirements and Connectors

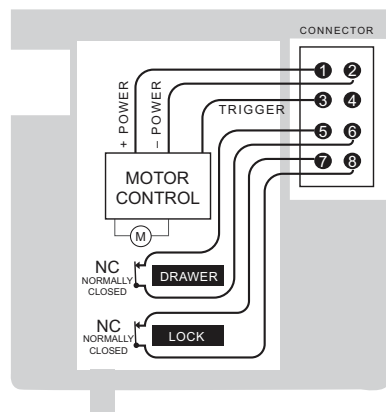
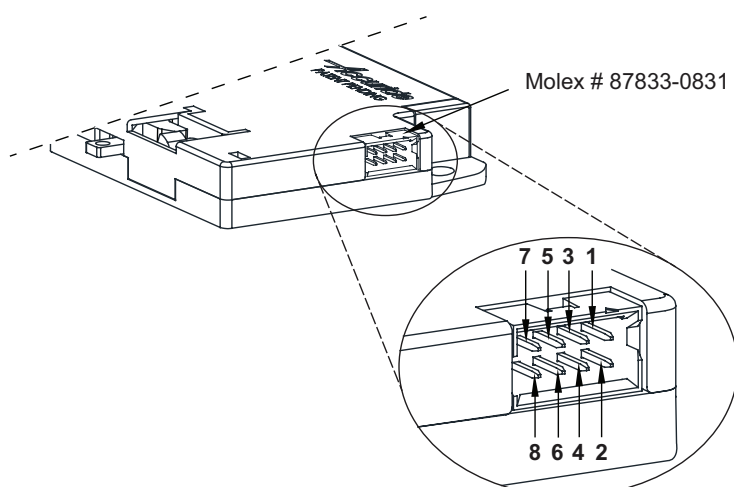

- 1 — Power (+5 to +30 VDC)
- 2 — Power (-)
- 3 — Trigger (+5 to +30 VDC)
- 4 — No Connection
- 5 } Drawer Status Switch
- 6 }
- 7 } Lock Status Switch
- 8 }

Wiring Schematic

PIN	COLOR	
1	RED	PWR (+5VDC to +30VDC)
2	BLACK	PWR (-)
3	GREEN	Trigger (+5 to +30 VDC)
4	NO WIRE*	
5	BROWN	Drawer Status
6	ORANGE	
7	GRAY	Lock Status
8	YELLOW	

Technical Data

Voltage Supply: +5VDC to +30VDC
 Current Consumption: 100 mA/0.2 seconds
 (Unlocking/Locking)

Micro-Switch Specifications

Contact Rating: 0.3A @ 6VDC
 Electrical Life: 50,000 cycles typical
 Mechanical Life: 100,000 cycles

Notes:

1. Drawer status switch:
 Drawer open: switch = closed
 Drawer closed: switch = open
2. Lock status switch:
 Lock is unlocked: switch = closed
 Lock is locked: switch = open
3. Trigger voltage (+) VDC at pin 3 will unlock EL.
 EL will remain unlocked until +VDC is removed from pin 3.
4. (*) Pin 4 is not used.

Distributor Bulk Pack (P): Includes one box with four boxes packed inside. Each sub box includes one pair of slides (one locking and one non-locking companion slide), and a 12" cable with 8-pin Molex connector.

Optional Accessories

P/N CBLEL-60 = 6' cable

Specifications

Slide members and ball retainers: Cold rolled steel
 Ball bearings: Carburized steel/acetal polymer
 Lock: Zinc and black polymer
 RoHS compliant

NOTE: Specifications, materials, prices, terms, and delivery are subject to change without notice.

Slide Ordering Instructions

C 38EL KO XXP (Kick-out-option)

C 38EL XXP (Lock/Unlock)

Complete your slide order for 38EL by specifying the following:

	8 prs*	C	38EL	KO	14	P
Total Slides Required						
Slide Finish						
Slide Model						
Kick-Out Option						
Slide Length						
Packaging						

* Full box quantities

Accuride's Electronic Lock is warranted against defects in workmanship or materials under normal use for one (1) year after date of purchase from an authorized Accuride distributor. This limited warranty only covers the lock and its internal components. If the lock is attached to an Accuride slide, the slide is covered under Accuride's Limited Lifetime Warranty. If attached to an activation device, the activation device is covered under a separate warranty from the manufacturer.

Accuride will repair or replace (as determined by Accuride or its authorized representative at its sole discretion) defective products at no charge to the original purchaser within the warranty period so long as the original purchaser returns the product, shipping prepaid, to Accuride or an authorized Accuride distributor. This represents Accuride's sole warranty obligation to original purchasers of its product.

This warranty is non-transferrable. To the maximum extent permitted by applicable law, Accuride disclaims any other warranties, express or implied, including warranties of fitness for a particular purpose and warranties of merchantability. Accuride will not be liable for any damages whatsoever arising out of the use or inability to use the Electronic Lock, even if Accuride has been advised of the possibility of such damages. Accuride shall not be responsible for incidental or consequential damages; because some states or jurisdictions do not allow the exclusion or limitation of liability for consequential or incidental damages, the foregoing limitation may not apply. Any repair or modification of the Electronic Lock not performed or specifically authorized by Accuride will void the warranty provided above.

Accuride will not be responsible for damage to the Electronic Lock caused by misuse, abuse, failure to properly package the product for return to Accuride, or for damage caused by carriers during shipment either to or from Accuride or an authorized Accuride distributor.

This warranty does not extend to any damage to products used in conjunction with the Electronic Lock. Any repairs necessitated by misuse, abuse, or shipping damage to the Electronic Lock or repairs of defective Electronic Lock returned after the warranty period has expired will be performed at the current rates.

For repair or replacements of an Electronic Lock, please send the damaged unit to the following address, only after obtaining authorization from Accuride.

Accuride International Inc.
Attn: Technical Services
Accuride/AF Romero
Calexico, CA 92231
www.accuride.com

Accuride

ACCURIDE INTERNATIONAL INC.

12311 Shoemaker Avenue
 Santa Fe Springs, CA 90670

TEL (562) 903-0200
 FAX (562) 903-0208
www.accuride.com

Manufacturing, Engineering, and Sales
 United States • Germany • Japan • Mexico • United Kingdom • China

Copyright © 2014 Accuride International Inc. 3700-9550-R2-0314